

Pitch: .100" x .100"

## BOX HEADER VALUE LINE

### SPECIFICATIONS

#### **ENVIRONMENTAL**

Temperature Range: -55°C to +105°C

#### **MECHANICAL**

Insulator Material: Glass-filled thermoplastic, black, UL94V-0

Contact Material: Copper Alloy

Contact Plating: Gold Flash

#### **ELECTRICAL**

Current Rating: 1 AMP

Consult factory for additional options

## CA-POSITION HL2-1A

POSITION	
08	30
10	34
12	40
14	44
16	50
20	60
24	64
26	

DIMENSIONS			
Position	A	B	C
08	.699 [17.75]	.613 [15.57]	.300 [7.62]
10	.799 [20.29]	.713 [18.11]	.400 [10.16]
12	.899 [22.83]	.813 [20.65]	.500 [12.70]
14	.999 [25.37]	.913 [23.19]	.600 [15.24]
16	1.099 [27.91]	1.013 [25.73]	.700 [17.78]
20	1.299 [32.99]	1.213 [30.81]	.900 [22.86]
24	1.499 [38.07]	1.413 [35.89]	1.10 [27.94]
26	1.599 [40.61]	1.513 [38.43]	1.20 [30.48]
30	1.799 [45.69]	1.713 [43.51]	1.40 [35.56]
34	1.999 [50.77]	1.913 [48.59]	1.60 [40.64]
40	2.299 [58.39]	2.213 [56.21]	1.90 [48.26]
44	2.499 [63.47]	2.413 [61.29]	2.10 [53.34]
50	2.799 [71.09]	2.713 [68.91]	2.40 [60.96]
60	3.299 [83.79]	3.213 [81.61]	2.90 [73.66]
64	3.499 [88.87]	3.413 [86.69]	3.10 [78.74]

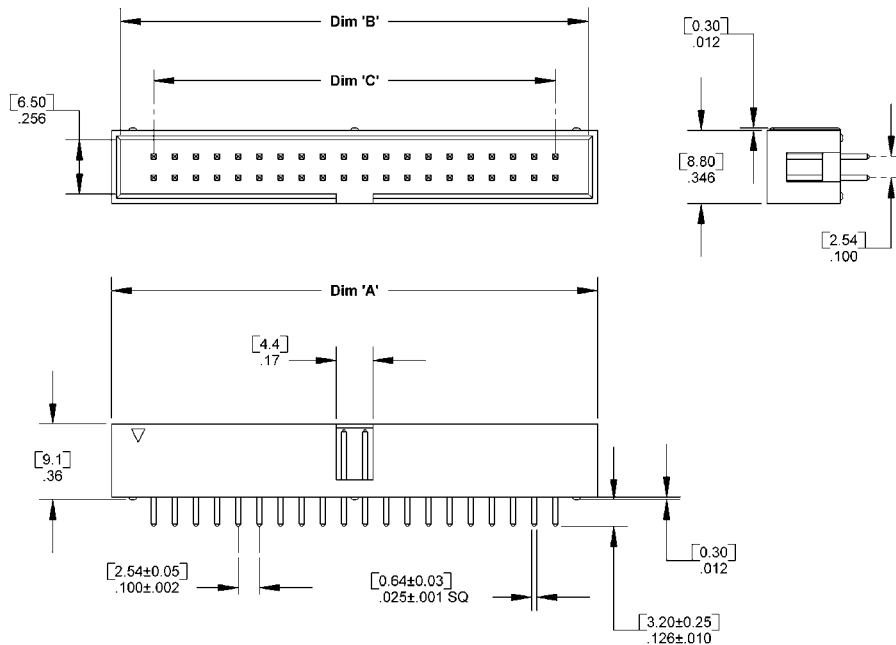

Mating Product: IDS2 (page 80), IDS3 (page 78), FID (page 79), ATAS (page 42)

Drawing Number: CA-620411



For more information please contact our customer service department or visit our website at circuitassembly.com

Circuit Assembly Worldwide Hqtrs. 3A Vanderbilt, Irvine, CA 92618-2030 USA Tel 1-949-855-7887 Fax 1-949-855-4298