

PART NO. CA-20MDPP-X-X-X-X-X

| REVISIONS | | | |
|-----------|--|-----------------|----------|
| LTR | DESCRIPTION | DATE | APPROVED |
| B | CHANGE THE MATERIAL(John SEE DO H3602) | 09/29/09' | RaY |
| C | MODIFY THE DIMENSION(John SEE DO H3855) | 03/03/10' | RaY |
| D | ADD THE PCB(John SEE DO H4295) | 08/26/10' | RaY |
| E | MODIFY THE P/N(John SEE DO H4333) | 09/20/10' | RaY |
| F | ADD THE PACKAGING(Colin SEE DO H5235) | 07/24/12' | RaY |
| G | CHANGE THE NEW FRAME AND CRITICAL DIMENSION SEE DO H8068 | 07/24/14' | RaY |
| H | UPDATE ROHS SEE DO H8219 | JAMES 07/12/19' | RaY |

D

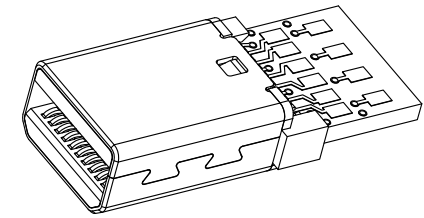
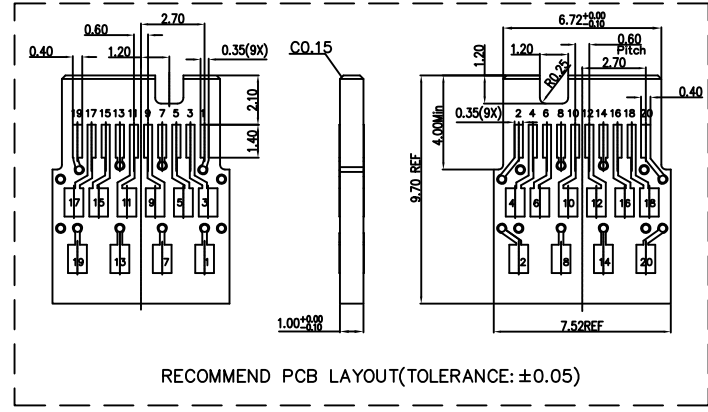
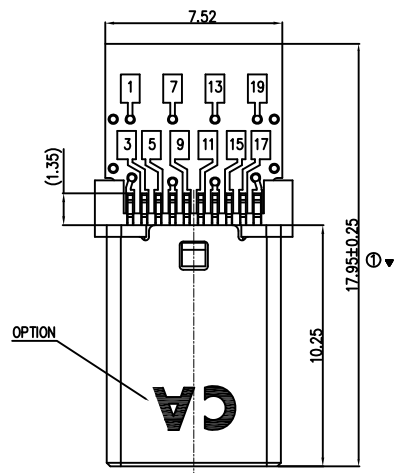

C

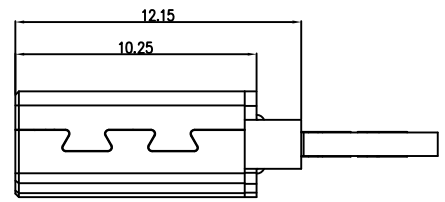
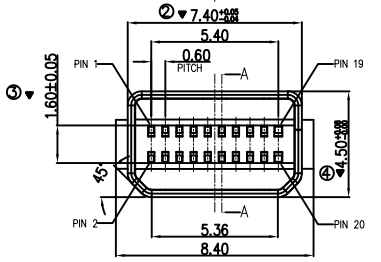

ORDERING NOMENCLATURE:

CA-20MDPP-X-X-X-X

ENCLOSURE MOUNT
 20MDPP=MINI DISPLAY PORT PLUG
 CONTACT PLATING:
 A=6/F D=5u"
 C=15u" F=30u"
 SHELL PLATING:
 1=Ni
 2=Au
 3=WITHOUT SHELL
 LOGO
 1=WITH CA LOGO
 2=WITHOUT CA LOGO
 PCB
 BLANK= WITH PCB
 1= WITHOUT PCB
 PACKAGING:
 BLANK= TRAY
 T= TUBE

B

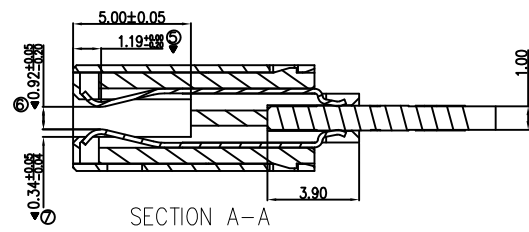
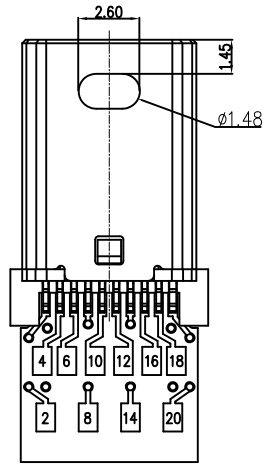

- NOTES:
- MATERIAL :
 HOUSING : LCP E130I,UL94V-0, COLOR : NATURAL.
 TERMINAL: PHOSPHOR BRONZE, THICKNESS=0.20mm.
 SHELL: SPCC, THICKNESS=0.30mm.
 PCB: SHALL BE 1OZ. COPPER CLAD BOTH SIDES, FR-4,
 GFN0625A/AIAC PER MIL-P-13949 IS PERMISSIBLE ERIAL.
 AS ALTERNATE MAT
 - TERMINAL PLATING :
 CONTACT AREA : Au PLATED AT CONTACT AREA
 SOLDER TAIL : 100 u" BRIGHT TIN PLATED,
 UNDER PLATE: 50 u" MINIMUM NICKEL (Ni).
 SHELL PLATING :
 100 u" MINIMUM NICKEL UNDER PLATED or G/F.
 - MARK "▼"DIMENSION MUST CONTROL. MARK "⊙"IS DIMENSION NO.
 - MEETS THE REQUIREMENTS OF THE EUROPEAN PARLIAMENT AND THE RESTRICTION OF THE USE OF CERTAIN HAZARDOUS SUBSTANCES IN ELECTRICAL AND ELECTRONIC EQUIPMENT. (ROHS)
 - MEETS THE HALOGEN FREE.

A

DIMENSIONS ARE IN MILLIMETERS
 TOLERANCES ARE:
 DECIMALS ANGLES
 X ±.25 ±3°
 XX ±.13
 XXX ±.05
 DIMENSIONS IN BRACKETS [X.XX]
 ARE IN INCHES TOLERANCES ARE:
 DECIMALS ANGLES
 X ±.010 ±3°
 XX ±.005
 XXX ±.001
 DO NOT SCALE DRAWING

| APPROVALS | DATE |
|--------------|----------|
| DRAWN John | 04/14/09 |
| CHECKED Roy | 04/14/09 |
| APPROVED Roy | 04/14/09 |

| | | | |
|--|----------------|--------------|------|
| CIRCUT ASSEMBLY SHENZHEN AO XING ROAD, A OBEI 2ND VILLAGE, HENGANG TOWN | | | |
| 20PIN MINI DISPLAY PORT PLUG ASSEMBLY(RoHS) | | | |
| SIZE | CODE IDENT NO. | DRAWING NO. | REV. |
| C | 52072 | H620129 | II |
| SCALE: 1:1 | | SHEET 1 OF 1 | |

4

3

4

2

1