



Pitch: .050"

## RIBBON HIGH DENSITY IDT PLUG

### SPECIFICATIONS

#### ENVIRONMENTAL

Temperature Range: -55°C to +105°C

#### MECHANICAL

Insulator Material: Glass-filled thermoplastic, black, UL94V-0

Shell Material: Steel

Contact Material: Copper Alloy

Contact Plating: 10µ IN sel gold

Terminates to: Discrete cable, 28 or 30 AWG

#### ELECTRICAL

Current Rating: 1 AMP

Consult factory for additional plating options

CA-  RHDP-B-ID-

POSITION	WIRE GAUGE
20 50	28 = 28 AWG
26 68	30 = 30 AWG

DIMENSIONS			
Position	A	B	C
20	.827 [21.01]	.450 [11.43]	.654 [16.61]
26	.977 [24.82]	.600 [15.24]	.804 [20.42]
50	1.577 [40.06]	1.200 [30.48]	1.404 [35.66]
68	2.027 [51.49]	1.650 [41.91]	1.854 [47.09]

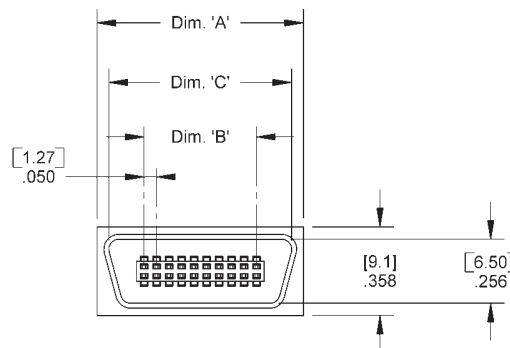
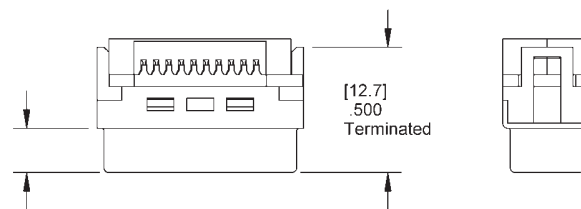
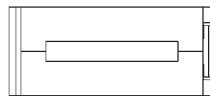

Backshell is available with connector

Plastic available with latch

Metal available in 50 & 68 positions

50 position - latch only

68 position - latch or jackscrew

Mating Product: RHDSR

Drawing Number CA-620384

For more information please contact our customer service department or visit our website at circuitassembly.com

Circuit Assembly Worldwide Hqtrs. 18 Thomas Street, Irvine, CA 92618-2777 USA Tel 1-949-855-7887 Fax 1-949-855-4298

Circuit Assembly Asia Hqtrs. 2F, No. 10 Lane 24, Ho Ping Rd., Pan Chiao City, Taipei Hsien, Taiwan Tel +886 2-2951-9916 Fax +886 2-2954-9126