

P/N CA-68LDP-X-P-XX-X-X

REV.	DESCRIPTION	DO.	APPD.
D	SEE ECN	E9302008	Robbie Luo
E	CHINGE	H0500	Robbie Luo
F	CHANGE THE ORDERING NOMENCLATURE 06/12/08	H2916	RAY XIANG

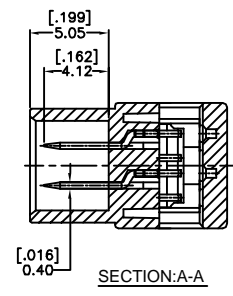
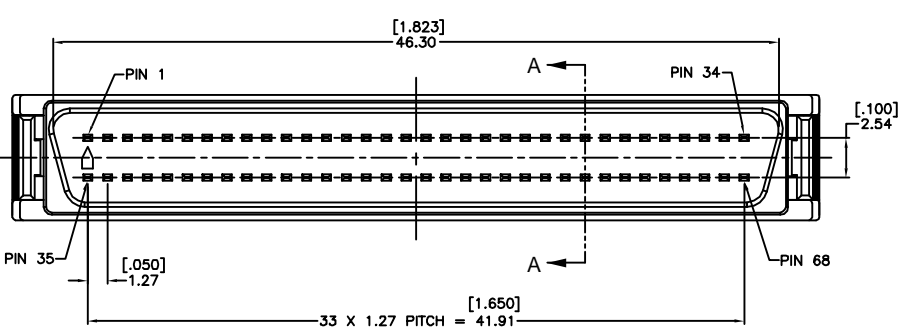
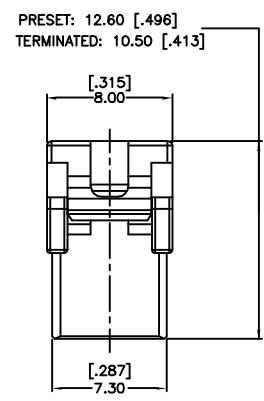
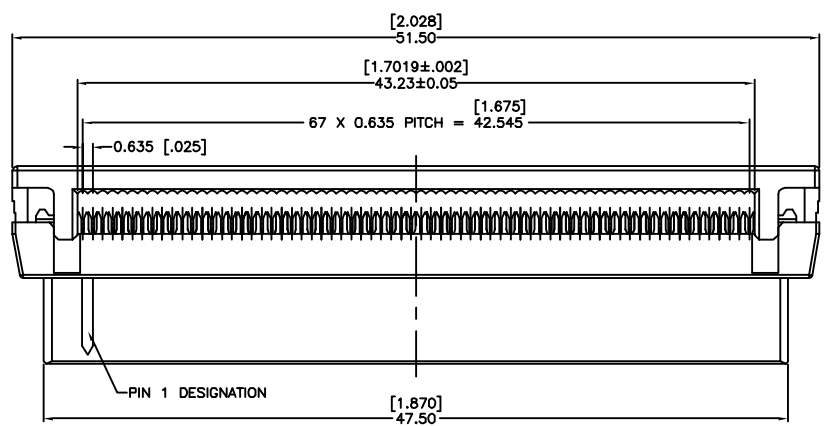
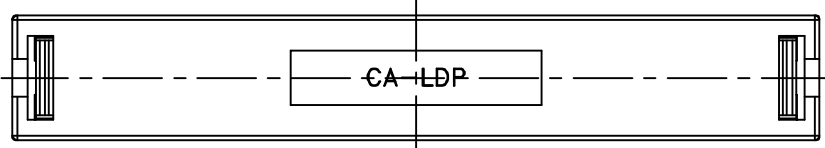

CA-68LDP-X-P-XX-X-X

NUMBER OF _____
 PIN POSITIONS _____
 LOW PROFILE _____
 HIGH DENSITY _____
 PLUG _____
 CONTACT PLATING _____

F = CONTACT AREA : .000030 [.00076] GOLD MIN.
 IDC AREA : .000150 [.00381] MIN PURE TIN
 UNDERPLATE : .000050 [.00191] NICKEL MIN.
 C = CONTACT AREA : .000015 [.000381] GOLD MIN.
 IDC AREA : .000150 [.00381] MIN PURE TIN
 UNDERPLATE : .000050 [.00191] NICKEL MIN.
 D = CONTACT AREA : .000005 [.000127] GOLD MIN.
 IDC AREA : .000150 [.00381] MIN PURE TIN
 UNDERPLATE : .000050 [.00191] NICKEL MIN.
 A = CONTACT AREA : GOLD FLASH
 IDC AREA : .000150 [.00381] MIN PURE TIN
 UNDERPLATE : .000050 [.00191] NICKEL MIN.

PLASTIC _____
 ACCESSORY _____
 BLANK=NO STRAIN RELIEF
 SR = STRAIN RELIEF

LOGO: _____
 BLANK OR 0=NO LOGO
 1=CA LOGO
 2=AMPHENOL

ADD IF REQUIRED _____
 U=THE COVER WILL BE PACKAGED SEPARATELY WITHOUT INSTALL SR

4. MEETS THE REQUIREMENTS OF DIRECTIVE 2002/95/EC OF THE EUROPEAN PARLIAMENT AND OF THE COUNCIL OF 27 JANUARY 2003 ON THE RESTRICTION OF THE USE OF CERTAIN HAZARDOUS SUBSTANCES IN ELECTRICAL AND ELECTRONIC EQUIPMENT.(ROHS)

3. APPLICABLE WIRE GAUGE : 30 AWG
 2. CONNECTOR WILL TERMINATE .025 CENTER RIBBON CABLE.

1. SPECIFICATIONS
 ENVIRONMENTAL: TEMPERATURE RANGE : -55° TO +105° C
 ELECTRICAL: CURRENT RATING : 0.5 AMPERES
 DIELECTRIC: WITHSTANDING VOLTAGE : 500 VDC FOR 1 MINUTE
 INSULATOR RESISTANCE : 1000 MEGOHMS MINIMUM

CONTACT RESISTANCE :
 a) LESS THAN 35 MILLIOHMS THROUGH INSULATION
 DISPLACEMENT PORTION AND PLUG/SOCKET INTERFACE.
 b) LESS THAN 15 MILLIOHMS THROUGH PLUG/SOCKET INTERFACE.

MECHANICAL
 INSULATOR MATERIAL: GLASS FILLED THERMOPLASTIC
 COLOR: BLACK , UL94V-0
 CONTACT MATERIAL : PHOSPHOR BRONZE
 DURABILITY : 500 CYCLES MINIMUM

NOTES: UNLESS OTHERWISE SPECIFIED

MILLIMETERS	INCH	UNITS	MM	NAME(INTENDED USE)	CIRCUIT ASSEMBLY SHENZHEN CA INDUSTRIAL BUILDING, AOXING ROAD, FUBEI SECOND VILLAGE, HENGANG TOWN, SHENZHEN CITY, GUANGDONG, PROVINCE, CHINA
X.± 2'	X.± 2'	MAT'L		LDP	
.X± 0.25	.X± .010			PART NO.(INTENDED USE)	TITLE
.XX± 0.13	.XX± .005	FINISH		CA-68LDP-X-P-XX-X-X	CONNECTOR ASSEMBLY LDP SERIES(ROHS)
.XXX± ----	.XXX± ----			APPD: Robbie lou10/04/04'	DWG NO.
THESE DRAWINGS AND SPECIFICATIONS ARE THE PROPERTY OF CIRCUIT ASSEMBLY SHEN ZHEN AND SHALL NOT BE REPRODUCED, COPIED OR USED IN ANY MANNER WITHOUT THE PRIOR WRITTEN CONSENT OF CIRCUIT ASSEMBLY SHEN ZHEN				Q'TY	H620049
				CHKD Eric Yan09/29/04'	SCALE SHEET REV. 1/1 1/1 F
				DR: Lucy Yan 09/29/04'	