

PART NO. CA-XXX-24X-46

REVISIONS			
LTR	DESCRIPTION	DATE	APPROVED
A	INITIAL RELEASE SEE DO 4528	C.P. 6-31-01	A.J.
B	SEE DO 5914	C.P. 10-20-05	L.F.
C	SEE DO 6036	C.P. 03-16-06	I.M.

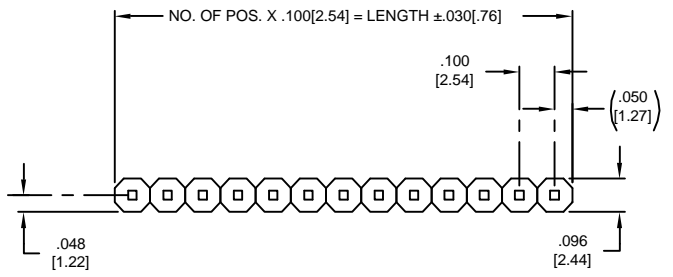

SINGLE ROW

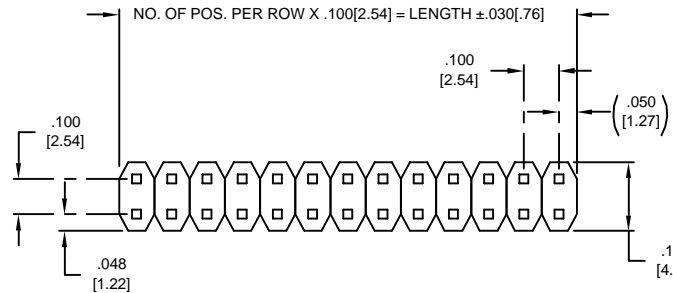
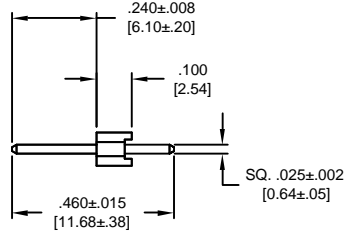

DUAL ROW

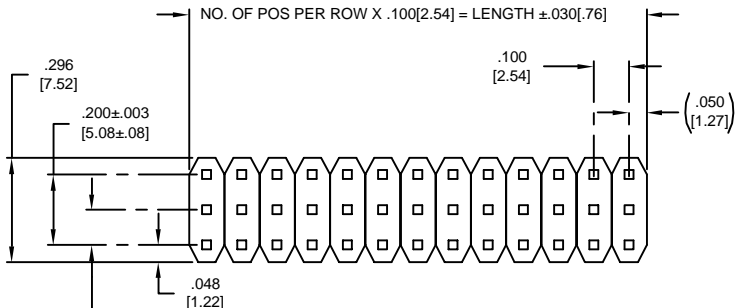
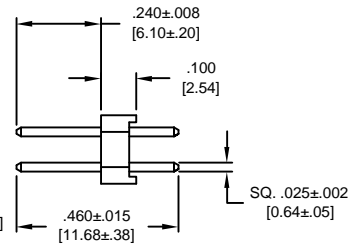

TRIPLE ROW

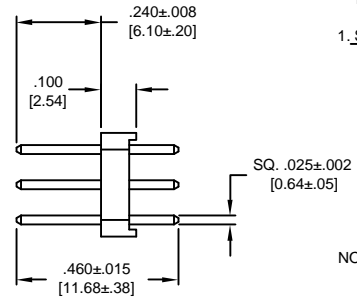

CA-XXX-24X-46

NO. OF ROW _____
 S = SINGLE ROW
 D = DUAL ROW
 T = TRIPLE ROW

NO. OF POSITIONS _____
 SINGLE ROW = 01-40 POSITIONS
 DUAL ROW = 04-80 POSITIONS
 TRIPLE ROW = 09-120 POSITIONS

POST EXTENSION _____
 .240 = [6.10]

PIN LENGTH _____
 46 = .460 [11.68]

PLATING _____
 A = GOLD FLASH
 B = .000010 [.00025] GOLD
 C = .000015 [.00038] GOLD
 TAIL AREA : .000150 [.00381] TIN
 UNDERPLATE : .000075 [.00190] NICKEL
 T = .000150 TIN OVER .000075 [.00190] NICKEL

2. MEETS THE REQUIREMENTS OF DIRECTIVE 2002/95/EC OF THE EUROPEAN PARLIAMENT AND OF THE COUNCIL OF 27 JANUARY 2003 ON THE RESTRICTION OF THE USE OF CERTAIN HAZARDOUS SUBSTANCES IN ELECTRICAL AND ELECTRONIC EQUIPMENT. (ROSH)

1. SPECIFICATIONS :

- ENVIRONMENTAL :**
 - TEMPERATURE RANGE : -55° TO +120° C
- MECHANICAL :**
 - INSULATOR MATERIAL : GLASS FILLED POLYESTER, BLACK, UL94V-0
 - CONTACT MATERIAL : COPPER ALLOY
- ELECTRICAL :**
 - CURRENT RATING : 1 AMP
 - DIELECTRIC WITHSTANDING VOLTAGE : 500 Vrms
 - INSULATION RESISTANCE : > 1000 Megohms

NOTES : UNLESS OTHERWISE SPECIFIED

DIMENSIONS ARE IN INCHES TOLERANCES ARE:	
DECIMALS	ANGLES
XX ± .010	± 3°
XXX ± .005	
DIMENSIONS IN BRACKETS [X.XX] ARE IN MILLIMETERS TOLERANCES ARE:	
DECIMALS	ANGLES
X ± .25	± 3°
XX ± .13	
DO NOT SCALE DRAWING	

APPROVALS	DATE
DRAWN CUONG.P	6-12-01
CHECKED A.JOCHEN	6-13-01

CA CIRCUIT ASSEMBLY CORP.
 18 THOMAS ST., IRVINE, CALIFORNIA 92618-2777

CONNECTOR ASSEMBLY		
.025" SQ. STRIP-HEADER, VALUE LINE		
CA-XXX-24X-46 - "ROHS COMPLIANT"		
SIZE	CODE IDENT NO.	DRAWING NO.
C	52072	620390
REV.		C
SCALE: 4 : 1		SHEET 1 OF 1