

PART NO. CA-XXIDSL-1T-X

REVISIONS				
LTR	DESCRIPTION	DATE	APPROVED	
A	INITIAL RELEASE SEE DD 3734	JL 11-19-99	A.J	
B	SEE DD 4009	JL 05-10-00	A.J	
C	SEE DD 4612	C.P 09-05-01	A.J	
D	SEE DD 5461	C.P 04-28-04	A.J	
E	SEE DD 6273	C.P 11-06-06	I.M.	
F	SEE DD 6479	C.P 07-10-07	A.J	
G	SEE DD 6601	C.P 02-21-08	A.J	
H	SEE DD 6955	C.P 04-30-10	A.J	
J	SEE DD 7521	C.P 04-19-19	T.L.	

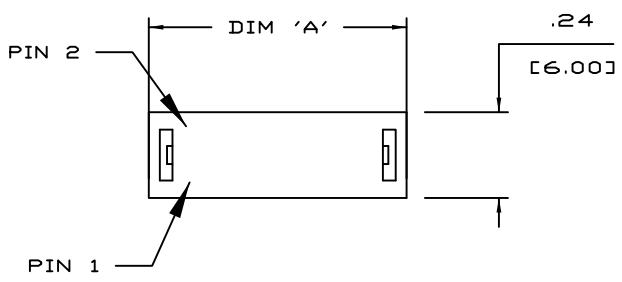

CA-XX IDSL-1T-X

NUMBER OF POSITIONS _____
 INSULATION DISPLACEMENT _____
 SLIM LINE _____
 TAIL TYPE _____
 1 = SOLDER TAIL
 PLATING _____
 T = TIN
 TAIL TYPE _____
 BLANK = STANDARD
 2 = SELF RETAINING

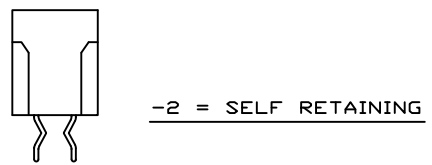
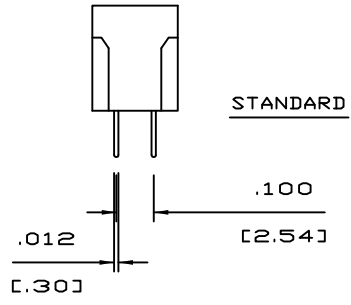
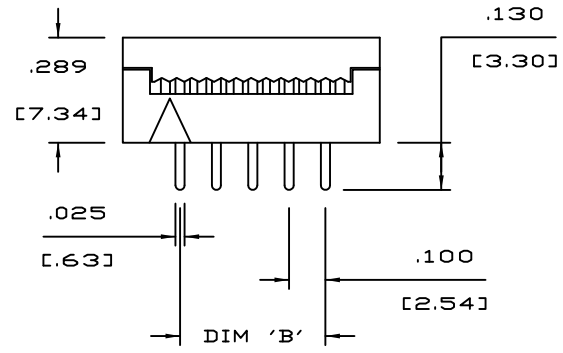

POS	DIM 'A'	DIM 'B'
06	.510 [12.95]	.20 [5.08]
08	.610 [15.49]	.30 [7.62]
10	.710 [18.03]	.40 [10.16]
12	.810 [20.57]	.50 [12.70]
14	.910 [23.11]	.60 [15.24]
16	1.010 [25.65]	.70 [17.78]
20	1.210 [30.73]	.90 [22.86]
24	1.410 [35.81]	1.10 [27.94]
26	1.510 [38.35]	1.20 [30.48]
28	1.610 [40.89]	1.30 [33.02]
30	1.710 [43.43]	1.40 [35.56]
34	1.910 [48.51]	1.60 [40.64]
40	2.210 [56.13]	1.90 [48.26]
50	2.710 [68.83]	2.40 [60.96]
60	3.210 [81.53]	2.90 [73.66]
64	3.410 [86.61]	3.10 [78.74]

1. MEETS THE REQUIREMENTS OF THE EUROPEAN PARLIAMENT AND THE RESTRICTION OF THE USE OF CERTAIN HAZARDOUS SUBSTANCES IN ELECTRICAL AND ELECTRONIC EQUIPMENT. (ROHS)

2. TERMINATES TO: .050 PITCH CABLE, 28 AWG

1. SPECIFICATIONS
 ENVIRONMENTAL:
 -TEMPERATURE RANGE : -55°C TO 105°C
 MECHANICAL:
 - INSULATOR MATERIAL : GLASS-FILLED POLYESTER,, BLACK, UL94V-0
 - CONTACT MATERIAL : COPPER ALLOY
 - CONTACT PLATING (All OVER) : .000100" TIN
 UNDERPLATE: .000040" NICKEL

ELECTRICAL:
 -CURRENT RATING : 1 AMP

NOTES: UNLESS OTHERWISE SPECIFIED

DIMENSIONS ARE IN INCHES TOLERANCES ARE:		APPROVALS		DATE	CIRCUIT ASSEMBLY CORP. 3A VANDERBILT, IRVINE, CALIFORNIA 92618-2030	
DECIMALS	ANGLES	DRAWN	J. LANG	11-16-99		
.XX ± .01	± 3°	CHECKED	A. JOCHEN	11-16-99	IDT SLIM LINE PLUG IDSL SERIES "ROHS COMPLIANT"	
.XXX ± .005		THE INFORMATION AND DESIGN DISCLOSED HEREIN WAS ORIGINATED BY AND IS THE PROPERTY OF CIRCUIT ASSEMBLY CORPORATION. ASSEMBLY CORPORATION RESERVES ALL PATENT, PROPRIETARY, DESIGN, MANUFACTURING, REPRODUCTION, USE AND SALES RIGHTS THEREIN, AND TO ANY ARTICLES INCLUDED HEREIN EXCEPT TO THE EXTENT RIGHTS ARE EXPRESSLY GRANTED TO OTHERS. THE FOREGOING DOES NOT APPLY TO VENDOR PROPRIETARY RIGHTS.		SIZE CODE IDENT NO. C 52072		DRAWING NO. 620388
DIMENSIONS IN BRACKETS [XXX] ARE IN MILLIMETERS TOLERANCES ARE: DECIMALS ANGLES .X ± .3 .XX ± .13		DO NOT SCALE DRAWING		SCALE: 4 : 1	SHEET 1 OF 1	