

PART NO. CA-XXDPD

# CA-25DPD SHOWN

## REVISIONS

LTR	DESCRIPTION	DATE	APPROVED
A	INITIAL RELEASE SEE ECR 558	09-21-87	A.J.
B	SEE DO 4127	CP 08-22-00	A.J.
C	SEE DO 5365	CP 01-05-04	A.J.
D	SEE DO 7030	CP 11-18-10	I.M.

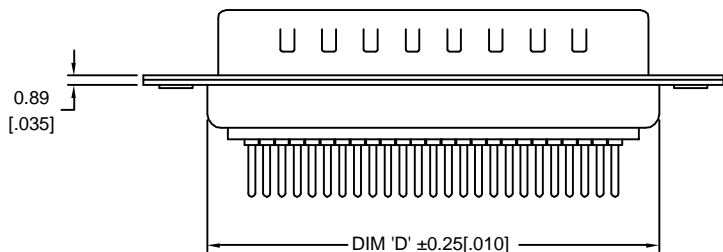
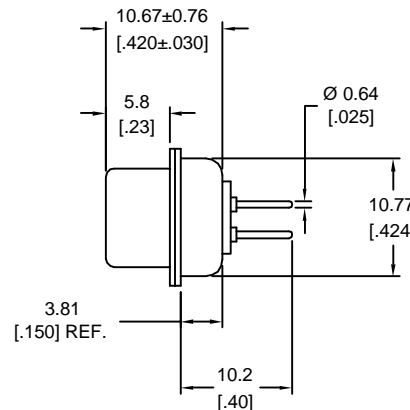
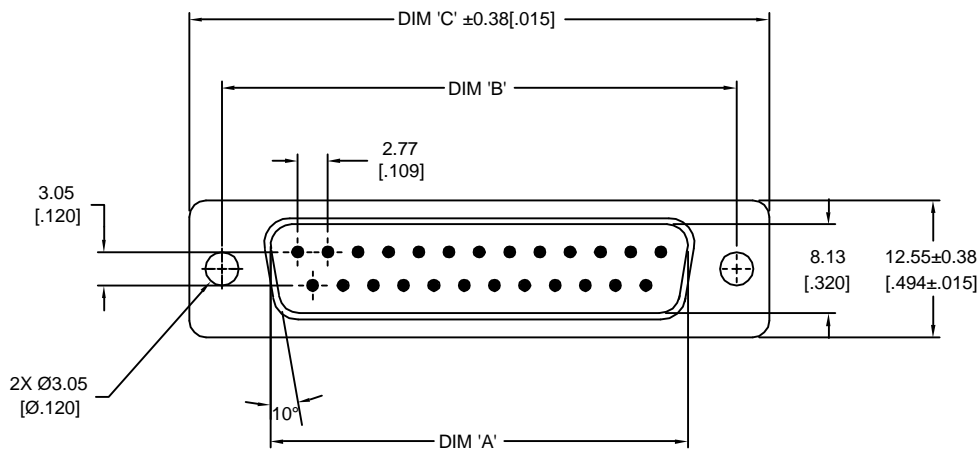

ORDERING NOMENCLATURE:

# CA-XXDPD

NO OF POSITION

"D" SUBMINIATURE PLUG

CONTACT TYPE

D = DIP SOLDER

6. MEETS THE REQUIREMENTS OF DIRECTIVE 2002/95/EC OF THE EUROPEAN PARLIAMENT AND OF THE COUNCIL OF 27 JANUARY 2003 ON THE RESTRICTION OF THE USE OF CERTAIN HAZARDOUS SUBSTANCES IN ELECTRICAL AND ELECTRONIC EQUIPMENT. (ROHS)

5. CA-25DPD SHOWN FOR ILLUSTRATION ONLY.

### 4. TABULATION:

NO OF POSITION	DIM 'A'		DIM 'B'		DIM 'C'		DIM 'D'	
	MM	IN	MM	IN	MM	IN	MM	IN
9	16.92	0.666	24.99	0.984	30.81	1.213	19.28	0.759
15	25.25	0.994	33.32	1.312	39.14	1.541	27.51	1.083
25	38.96	1.534	47.04	1.852	53.04	2.088	41.28	1.625
37	55.42	2.182	63.50	2.500	69.32	2.729	57.71	2.272

3. SHELL MATERIAL: SPCC-SD, NICKEL & TIN PLATED.

2. CONTACT MATERIAL: BRASS, PLATING: GOLD PLATED OVER NICKEL.

1. INSULATOR MATERIAL: POLYESTER GLASS FILLED, UL94V-0, COLOR BLACK

NOTES : UNLESSS OTHERWISE SPECIFIED

DIMENSIONS ARE IN MILLIMETERS TOLERANCES ARE:	APPROVALS	DATE	<b>CIRCUIT ASSEMBLY CORP.</b> 18 THOMAS ST., IRVINE, CALIFORNIA 92618-2777		
	DRAWN IAN MORRELL	8-22-00			
DECIMALS ANGLES X ±.25 .XX ±.13	CHECKED ART JOCHEN	8-22-00	CONNECTOR ASSEMBLY - "D" SUBMINIATURE TYPE: CA-DPD, P.C.B. MOUNT "ROHS"		
DIMENSIONS IN BRACKETS (XX) ARE INCHES TOLERANCES ARE:	THE INFORMATION AND DESIGN DISCLOSED HEREIN WAS ORIGINATED BY AND IS THE PROPERTY OF CIRCUIT ASSEMBLY CORPORATION. CIRCUIT ASSEMBLY CORPORATION RESERVES ALL PATENT, PROPRIETARY, DESIGN, MANUFACTURING, REPRODUCTION, USE AND SALES RIGHTS THEREIN, AND TO ANY ARTICLE DISCLOSED HEREIN EXCEPT TO THE EXTENT RIGHTS ARE EXPRESSLY GRANTED TO OTHERS. THE FOREGOING DOES NOT APPLY TO VENDOR PROPRIETARY RIGHTS.				
DECIMALS ANGLES XX ±.010 XXX ±.005	DO NOT SCALE DRAWING	SIZE C	CODE IDENT NO. 52072	DRAWING NO. 620276	REV. D
		SCALE: NONE	SHEET 1 OF 1		