

4

3

2

1

| PART NO. CA-24DVISDX-X-X | | | | | DESCRIPTION | | | DATE | | | APPROVED | | | REVISIONS | | |
|--------------------------|---|-------------|------|----------|-------------|-----|---|-----------------|-------------|----|----------|------|--|-----------|--|--|
| LTR | H | SEE DO 4337 | C.P. | 01-25-01 | A.J | LTR | A | INITIAL RELEASE | SEE DO 3961 | AJ | 04-04-00 | A.J. | | | | |
| | J | SEE DO 4567 | C.P. | 7-27-01 | A.J | | B | SEE DO 3986 | | AJ | 04-19-00 | B.W. | | | | |
| | K | SEE DO 4594 | C.P. | 8-20-01 | A.J | | C | SEE DO 3997 | | AJ | 04-26-00 | B.W. | | | | |
| | L | SEE DO 4714 | C.P. | 12-18-01 | A.J | | D | SEE DO 4024 | | JL | 06-02-00 | A.J. | | | | |
| | M | SEE DO 6248 | C.P. | 10-13-06 | I.M. | | E | SEE DO 4037 | | JL | 06-09-00 | J.L. | | | | |
| | | | | | | | F | SEE DO 4138 | | JL | 08-29-00 | B.W. | | | | |
| | | | | | | | G | SEE DO 4208 | | JL | 10-17-00 | A.J | | | | |

D

C

B

A

D

C

B

A

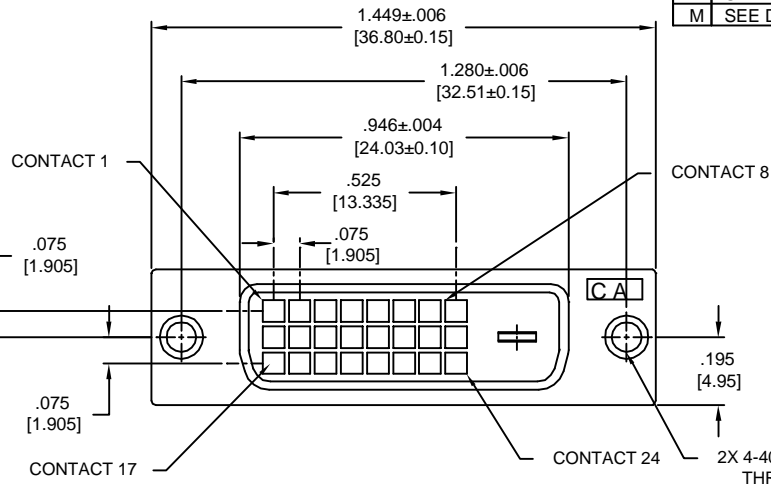

CA - 24 DVI S D V - X - X

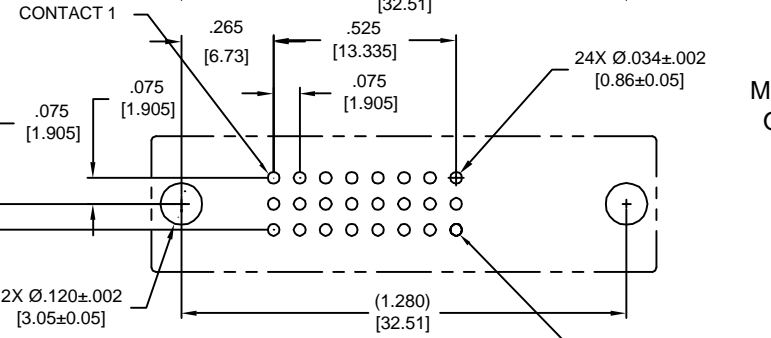
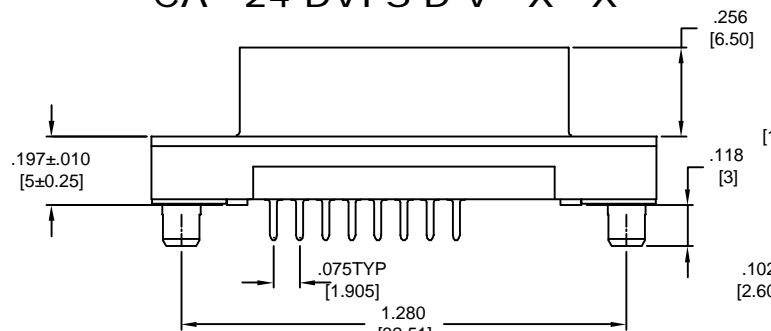

PC BOARD MOUNTING PATTERN COMPONENT SIDE

CA - 24 DVI S D X - X - X

- NO OF PIN POSITIONS
- DIGITAL VISUAL INTERFACE
- SOCKET
- PRODUCT TYPE: DIGITAL
- PROFILE:
 - V = VERTICAL WITH FIXED POST
 - B = VERTICAL WITHOUT FIXED POST
 - C = FOR CABLE (SOLDER TYPE) WITH FIXED POST
 - D = FOR CABLE (SOLDER TYPE) WITHOUT FIXED POST
 - E = VERTICAL, EXTENDED HEIGHT
- PLATING:
 - A = GOLD FLASH OVER NICKEL
 - C = .000015 [.00038] GOLD OVER NICKEL
 - F = .000030 [.00076] GOLD OVER NICKEL
- MOUNTING OPTION STYLES :
 - 1 = 4-40 UNC THREADED INSERT
 - 2 = 4-40 UNC HEX SCREWLOCK
 - (2 PCS. PER CONNECTOR; PACKAGED SEPARATELY)
 - 3 = 4-40 UNC HEX SCREWLOCK (INSTALLED)

NOTES :

- FOR SPECIFICATION AND PERFORMANCE CHARACTERISTICS SEE CA DWG 100252
- ENVIRONMENTAL :
TEMPERATURE RANGE -20°C TO +85°C
- ELECTRICAL :
RATED : 1.5A @ 40V AC (rms)
CONTACT RESISTANCE : 20 MLLIOHMS MAXIMUM
INSULATION RESISTANCE : 1000 MEGOHMS MINIMUM
DIELECTRIC WITHSTANDING VOLTAGE : 500V AC (rms)
- MECHANICAL :
MATING FORCE : 10 LB. (4.5kg) MAXIMUM
UNMATING FORCE : 2.2 LB. (1kg) MINIMUM, 8.8 L.B. (4kg) MAXIMUM
- MATERIAL :
HOUSING : GLASS FILLED THERMOPLASTIC, NATURAL, U.L 94V-0
CONTACT : PHOSPHOR BRONZE
SHELL : ZINC ALLOY, NICKEL PLATED
BOARD LOCK : ZINC ALLOY, TIN PLATED
- MEETS THE REQUIREMENTS OF DIRECTIVE 2002/95/EC OF THE EUROPEAN PARLIAMENT AND OF THE COUNCIL OF 27 JANUARY 2003 ON THE RESTRICTION OF THE USE OF CERTAIN HAZARDOUS SUBSTANCES IN ELECTRICAL AND ELECTRONIC EQUIPMENT. (ROHS)

MOUNTING OPTIONS

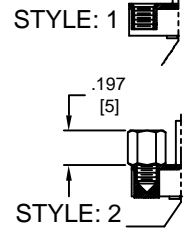

| | | | | | |
|---|--------|---|----------------|-------------|---|
| DIMENSIONS ARE IN INCHES TOLERANCES ARE: | | APPROVALS | | DATE | CIRCUIT ASSEMBLY CORP. 18 THOMAS ST., IRVINE, CALIFORNIA 92618-2777 |
| DECIMALS | ANGLES | DRAWN A. JOCHEN | | 3-31-00 | |
| .XX ± .010 | ±3° | CHECKED A. JOCHEN | | 3-31-00 | FEMALE DVI CONNECTOR DIGITAL 24DVISDX-X-X "ROHS COMPLIANT" |
| .XXX ± .005 | | THE INFORMATION AND DESIGN DISCLOSED HEREIN WAS ORIGINATED BY AND IS THE PROPERTY OF CIRCUIT ASSEMBLY CORPORATION. CIRCUIT ASSEMBLY CORPORATION RESERVES ALL PATENT, PROPRIETARY, DESIGN, TRADE SECRET, AND SALES RIGHTS HERETO, AND TO ANY ARTICLE DISCLOSED HEREIN EXCEPT TO THE EXTENT RIGHTS ARE EXPRESSLY GRANTED TO OTHERS. THE FOREGOING DOES NOT APPLY TO VISOR PROPRIETARY RIGHTS. | | SCALE: 4:1 | |
| DECIMALS | ANGLES | SIZE | CODE IDENT NO. | DRAWING NO. | REV. |
| X ± .25 | ±3° | C | 52072 | 610236 | M |
| .XX ± .12 | | | | | |

4

3

2

1

PART NO. CA-24DVISDX-X-X

| REVISIONS | | | |
|-----------|------------------|------|----------|
| LTR | DESCRIPTION | DATE | APPROVED |
| | SEE SHEET 1 OF 5 | | |

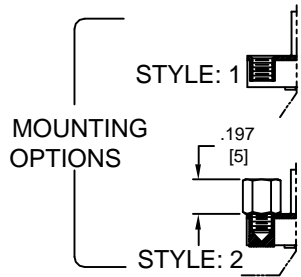
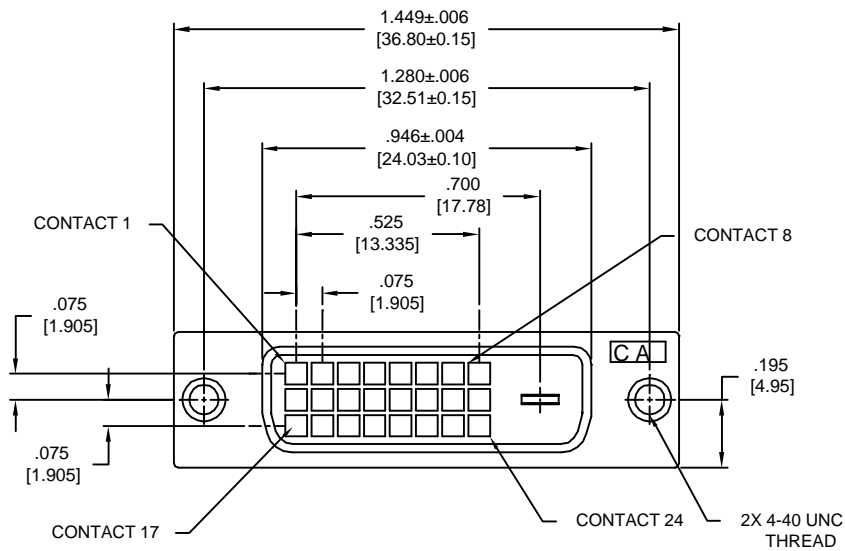

CA - 24 DVI SDC - X - X

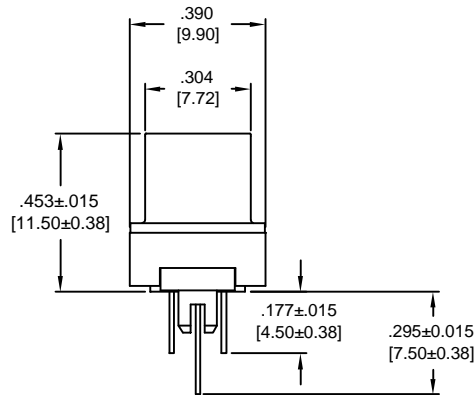
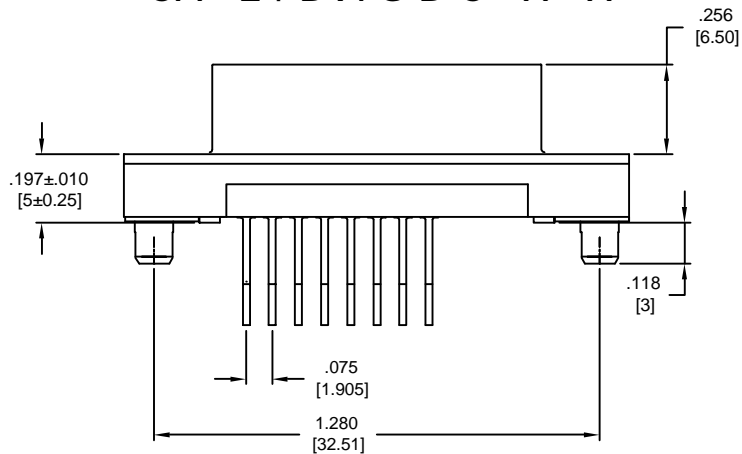

DIMENSIONS ARE IN INCHES
TOLERANCES ARE:
DECIMALS ANGLES
.XX ± .010 ±3°
.XXX ± .005

DIMENSIONS IN BRACKETS
TOLERANCES ARE:
DECIMALS ANGLES
X ± .25 ±3°
XX ± .13

DO NOT SCALE DRAWING

| APPROVALS | DATE |
|----------------------|---------|
| DRAWN A. JOCHEN | 3-31-00 |
| CHECKED A. JOCHEN | 3-31-00 |

| | | | |
|---|-------------------------|-----------------------|-----------|
| CIRCUIT ASSEMBLY CORP. 18 THOMAS ST., IRVINE, CALIFORNIA 92618-2777 | | | |
| FEMALE DVI CONNECTOR DIGITAL 24DVISDX-X-X "ROHS COMPLIANT" | | | |
| SIZE C | CODE IDENT NO. 52072 | DRAWING NO. 610236 | REV. M |
| SCALE: 4:1 | | SHEET 2 OF 5 | |

PART NO. CA-24DVISDX-X-X

| REVISIONS | | | |
|------------------|-------------|------|----------|
| LTR | DESCRIPTION | DATE | APPROVED |
| SEE SHEET 1 OF 5 | | | |

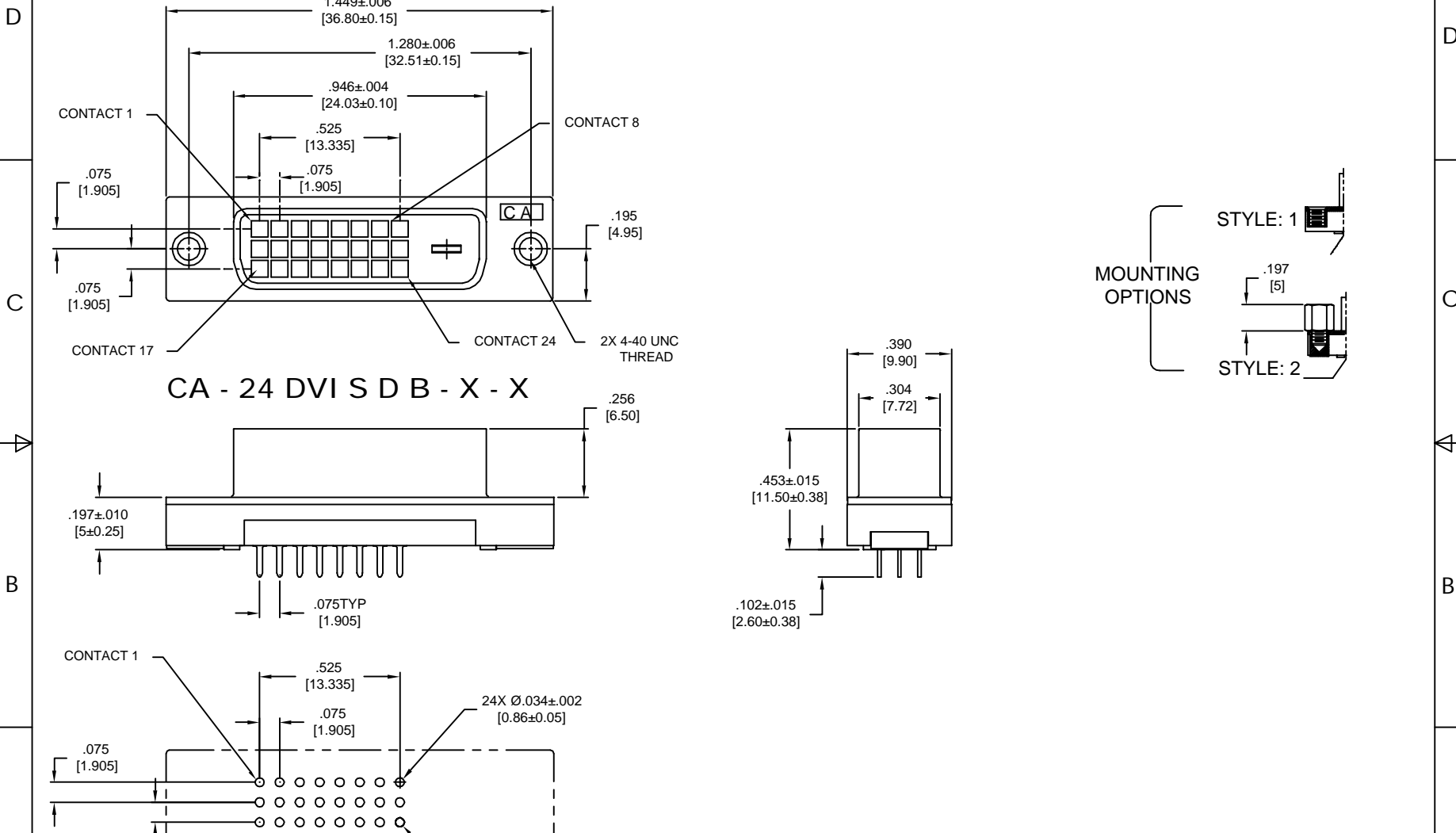

CA - 24 DVI S D B - X - X

PC BOARD MOUNTING PATTERN
COMPONENT SIDE

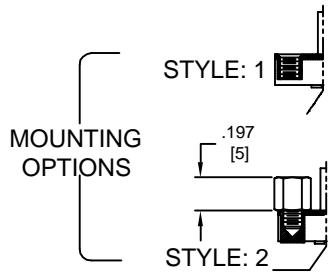

| | | | |
|--|--|---|---|
| DIMENSIONS ARE IN INCHES TOLERANCES ARE: DECIMALS ANGLES .XX ± .010 ±3° .XXX ± .005 | APPROVALS DRAWN A. JOCHEN 3-31-00 | DATE 3-31-00 | CIRCUIT ASSEMBLY CORP. 18 THOMAS ST., IRVINE, CALIFORNIA 92618-2777 |
| | CHECKED A. JOCHEN 3-31-00 | FEMALE DVI CONNECTOR DIGITAL 24DVISDX-X-X "ROHS COMPLIANT" | |
| DIMENSIONS IN BRACKETS [X.XX] ARE IN MILLIMETERS TOLERANCES ARE: DECIMALS ANGLES .X ± .25 ±3° .XX ± .13 | THE INFORMATION AND DESIGN DISCLOSED HEREIN WAS ORIGINATED BY AND IS THE PROPERTY OF CIRCUIT ASSEMBLY CORPORATION. CIRCUIT ASSEMBLY CORPORATION RESERVES ALL PATENT, PROPRIETARY, DESIGN, MANUFACTURING, REPRODUCTION, USE AND SALES RIGHTS THERE TO, AND TO ANY ARTICLES DISCLOSED HEREIN EXCEPT TO THE EXTENT RIGHTS ARE EXPRESSLY GRANTED TO OTHERS. THE FOREGOING DOES NOT APPLY TO VENDOR PROPRIETARY RIGHTS. | | SIZE C |
| DO NOT SCALE DRAWING | CODE IDENT NO. 52072 | DRAWING NO. 610236 | REV. M |
| SCALE: 4:1 | | SHEET 3 OF 5 | |

PART NO. CA-24DVISDX-X-X

| REVISIONS | | | |
|-----------|------------------|------|----------|
| LTR | DESCRIPTION | DATE | APPROVED |
| | SEE SHEET 1 OF 5 | | |

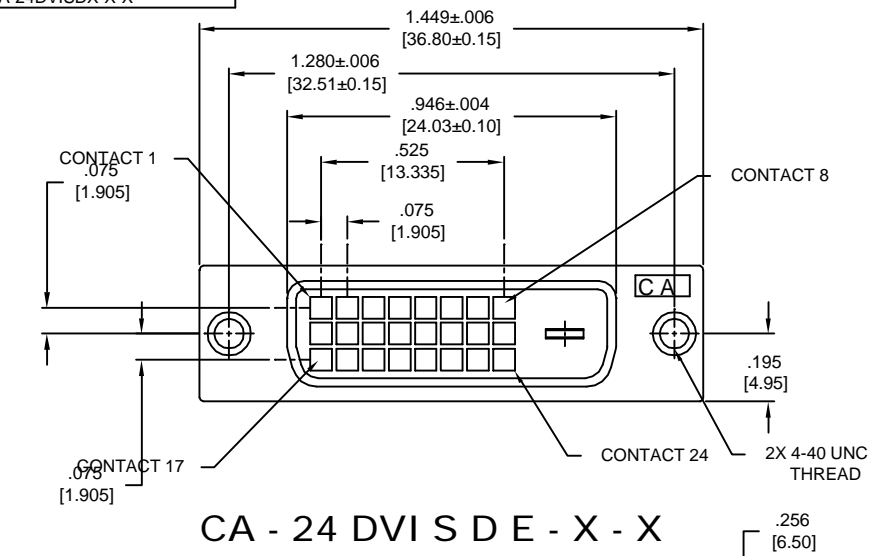

CA - 24 DVI S D E - X - X

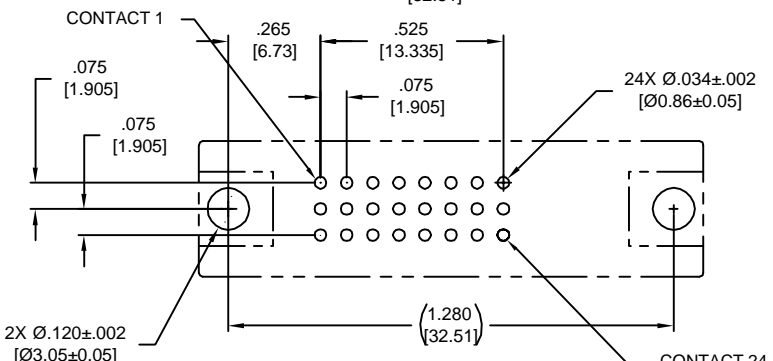
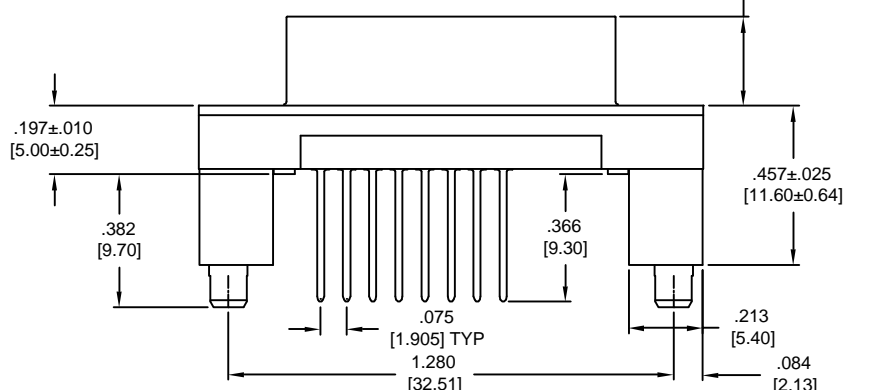

PC BOARD MOUNTING PATTERN
 COMPONENT SIDE

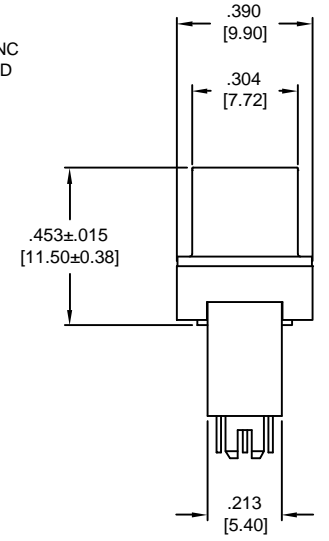

| | | | | |
|---|------------|--|-----------|---------|
| DIMENSIONS IN INCHES TOLERANCES ARE: | | APPROVALS | | DATE |
| .XX ± .010 | ANGLES ±3° | DRAWN | A. JOCHEN | 3-31-00 |
| .XXX ± .005 | | CHECKED | A. JOCHEN | 3-31-00 |
| DIMENSIONS IN BRACKETS [XXX] ARE IN MILLIMETERS TOLERANCES ARE: | | | | |
| .XX ± .25 | ANGLES ±3° | THE INFORMATION AND DESIGN DISCLOSED HEREIN WAS ORIGINATED BY AND IS THE PROPERTY OF CIRCUIT ASSEMBLY CORPORATION. CIRCUIT ASSEMBLY CORPORATION PRESERVES ALL PATENT, PROPRIETARY, DESIGN, MANUFACTURING, REPRODUCTION, USE AND SALES RIGHTS THEREIN, AND TO ANY ARTICLE DISCLOSED HEREIN EXCEPT TO THE EXTENT RIGHTS ARE EXPRESSLY GRANTED TO OTHERS. THE FOREGOING DOES NOT APPLY TO VENDOR, PROPRIETARY RIGHTS. | | |
| DO NOT SCALE DRAWING | | | | |

| | | |
|---|----------------|-------------|
| CIRCUIT ASSEMBLY CORP. 18 THOMAS ST., IRVINE, CALIFORNIA 92618-2777 | | REV. |
| FEMALE DVI CONNECTOR DIGITAL 24DVISDX-X-X "ROHS COMPLIANT" | | REV. |
| SIZE | CODE IDENT NO. | DRAWING NO. |
| C | 52072 | 610236 |
| SCALE: 4:1 | SHEET 4 OF 5 | |

PART NO. CA-24DVISDX-X-X

| REVISIONS | | | |
|-----------|------------------|------|----------|
| LTR | DESCRIPTION | DATE | APPROVED |
| | SEE SHEET 1 OF 5 | | |

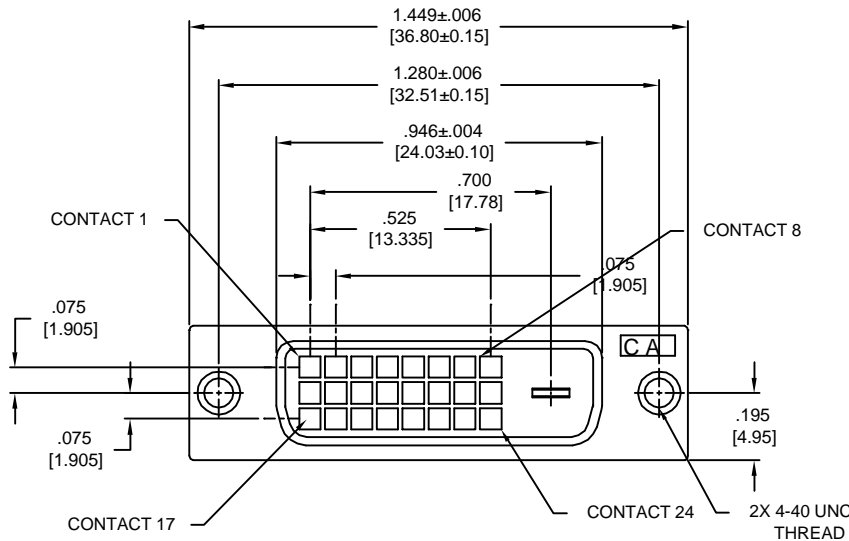

CA - 24 DVI S D D - X - X

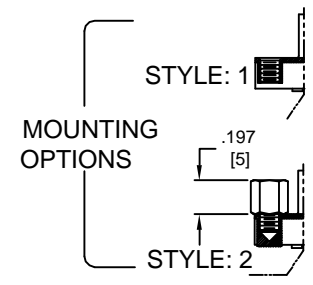
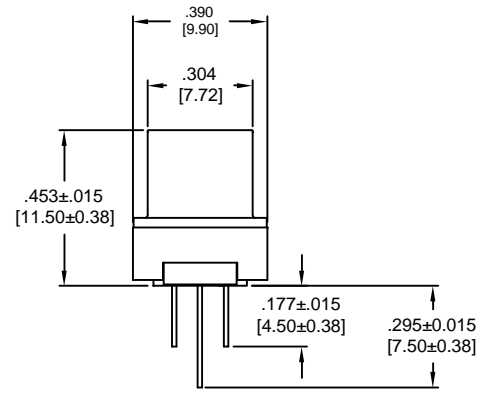
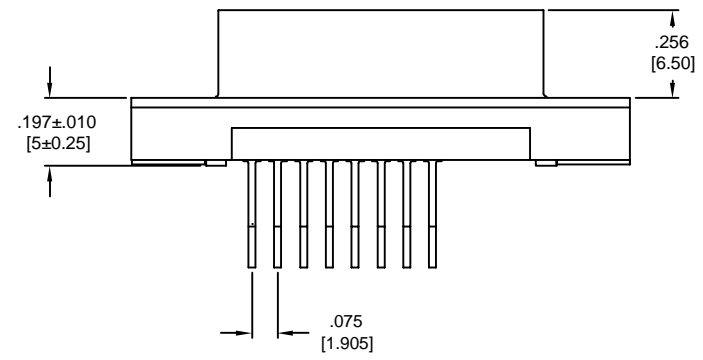

D
C
B
A

D
C
B
A

| | | | |
|---|---|-------------------------|--|
| DIMENSIONS ARE IN INCHES TOLERANCES ARE: DECIMALS ANGLES .XX ± .010 ±3° .XXX ± .005 | APPROVALS | DATE | CIRCUIT ASSEMBLY CORP. 18 THOMAS ST., IRVINE, CALIFORNIA 92618-2777 |
| | DRAWN A. JOCHEN | 3-31-00 | |
| DIMENSIONS IN BRACKETS [X.XX] ARE IN MILLIMETERS TOLERANCES ARE: DECIMALS ANGLES X ± .25 ±3° .XX ± .13 | CHECKED A. JOCHEN | 3-31-00 | FEMALE DVI CONNECTOR DIGITAL 24DVISDX-X-X "ROHS COMPLIANT" |
| | THE INFORMATION AND DESIGN DISCLOSED HEREIN WAS ORIGINATED BY AND IS THE PROPERTY OF CIRCUIT ASSEMBLY CORPORATION. CIRCUIT ASSEMBLY CORPORATION RESERVES ALL PATENT, PROPRIETARY, DESIGN, MANUFACTURING, REPRODUCTION, AND SALES RIGHTS THEREIN, AND TO ANY ARTICLE DISCLOSED HEREIN EXCEPT TO THE EXTENT RIGHTS ARE EXPRESSLY GRANTED TO OTHERS. THE FOREGOING DOES NOT APPLY TO THIRD-PARTY PROPRIETARY RIGHTS. | | |
| DO NOT SCALE DRAWING | SIZE C | CODE IDENT NO. 52072 | DRAWING NO. 610236 |
| | SCALE: 4:1 | | REV. M |
| | | | SHEET 5 OF 5 |