

PART NO. CA-XXSPC-T

REVISIONS				
LTR	DESCRIPTION	DATE	APPROVED	
A	INITIAL RELEASE SEE DO 3865	DL 2-8-00	A. J.	
B	SEE DO 4615	C.P 9-10-01	A. J.	

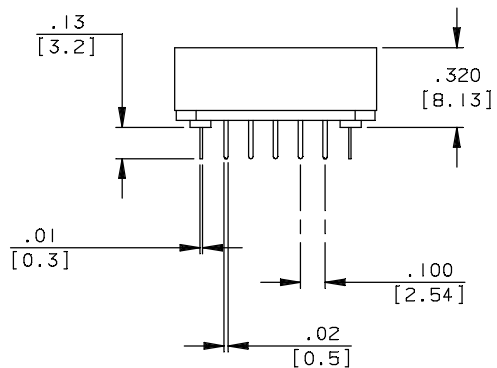
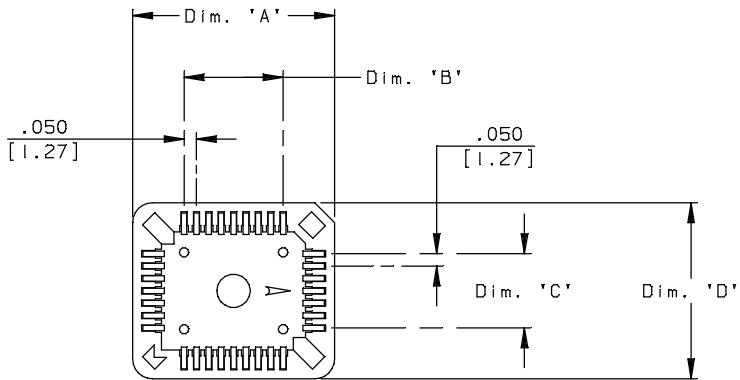

TABULATION

NO OF POSITIONS	DIM. 'A'	DIM. 'B'	DIM. 'C'	DIM. 'D'
20	.610 [15.50]	.200 [5.08]	.200 [5.08]	.610 [15.50]
28	.720 [18.30]	.300 [7.62]	.300 [7.62]	.720 [18.30]
32	.838 [21.30]	.400 [10.16]	.300 [7.62]	.838 [21.30]
44	.925 [23.50]	.500 [12.70]	.500 [12.70]	.925 [23.50]
52	1.019 [25.90]	.600 [15.24]	.600 [15.24]	1.019 [25.90]
68	1.224 [31.10]	.800 [20.32]	.800 [20.32]	1.224 [31.10]
84	1.417 [36.00]	1.000 [25.40]	1.000 [25.40]	1.417 [36.00]

- 6. FOR PIN NUMBER LAYOUT PATTERN SEE CA SPECIFICATION 100136
 - 5. TEMPERATURE RANGE: -55° TO 105° C
 - 4. CURRENT RATING: 1 AMP
 - 3. CONTACT PLATING: TIN
 - 2. CONTACT MATERIAL: COPPER ALLOY
 - 1. INSULATOR MATERIAL: GLASS FILLED POLYESTER, BLACK, UL94V-0
- NOTES: UNLESS OTHERWISE SPECIFIED

DIMENSIONS ARE IN INCHES TOLERANCES ARE: DECIMALS ANGLES .XX ± .010 ± 3° .XXX ± .005	APPROVALS	DATE	CA CIRCUIT ASSEMBLY CORP. 18 THOMAS ST., IRVINE, CALIFORNIA 92618-2777
	DRAWN	D. LANG 2-8-00	
DIMENSIONS IN BRACKETS [X.XX] ARE IN MILLIMETERS TOLERANCES ARE: DECIMALS ANGLES .X ± 0.25 ± 3° .XX ± 0.13	CHECKED	A. JOCHEN 2-8-00	CONNECTOR ASSEMBLY SPC SERIES
	THE INFORMATION AND DESIGN DISCLOSED HEREIN WAS ORIGINATED BY AND IS THE PROPERTY OF CIRCUIT ASSEMBLY CORPORATION. CIRCUIT ASSEMBLY CORPORATION RESERVES ALL PATENT, PROPRIETARY, DESIGN, MANUFACTURING, REPRODUCTION, USE AND SALES RIGHTS THERETO, AND TO ANY ARTICLE DISCLOSED HEREIN EXCEPT TO THE EXTENT RIGHTS ARE EXPRESSLY GRANTED TO OTHERS. THE FOREGOING DOES NOT APPLY TO VENDOR PROPRIETARY RIGHTS.		
DO NOT SCALE DRAWING	SIZE	CODE IDENT NO.	DRAWING NO.
	B	52072	610213
	SCALE: 2 : 1		REV. B
			SHEET 1 OF 1