

| REVISIONS |                             |      |          |      |
|-----------|-----------------------------|------|----------|------|
| LTR       | DESCRIPTION                 | DATE | APPROVED |      |
| A         | INITIAL RELEASE SEE DO 4659 | C.P  | 10-26-01 | L.F  |
| B         | SEE DO 5030                 | C.P  | 11-20-02 | A.J. |
| C         | SEE DO 5079                 | C.P. | 01-22-03 | A.J. |
| D         | SEE DO 5371                 | C.P. | 01-14-04 | A.J. |
| E         | SEE DO 5401                 | C.P. | 02-19-04 | A.J. |
| F         | SEE DO 5682                 | C.P. | 01-17-05 | A.J. |
| G         | SEE DO 7126                 | C.P. | 07-26-11 | I.M. |
| H         | SEE DO 7313                 | C.P. | 02-23-15 | I.M. |
| J         | SEE DO 7521                 | C.P  | 04-22-19 | T.L. |
| K         | SEE DO 7617                 | C.P  | 06-02-21 | T.L. |

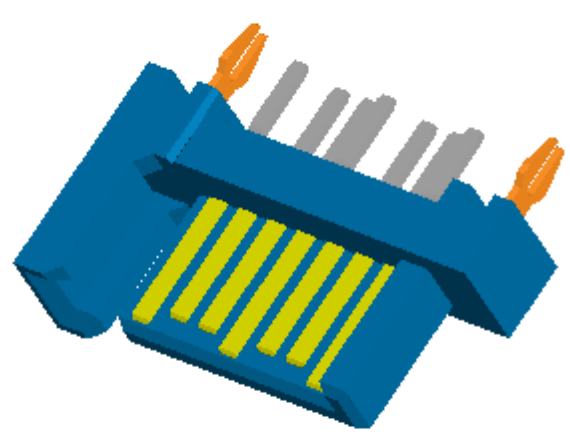

ORDERING NOMENCLATURE : **CA - 07SAHP-X-1-X**

**NUMBER OF CONTACT POSITION** \_\_\_\_\_

**SERIAL ATA HOST PLUG** \_\_\_\_\_

**PLATING** \_\_\_\_\_

A = CONTACT AREA : GOLD FLASH  
 C = CONTACT AREA : .000015 [.00038] GOLD  
 D = CONTACT AREA : .000005 [.00013] GOLD  
 F = CONTACT AREA : .000030 [.00076] GOLD

ALL WITH :  
 SOLDER TAIL AREA : .000150 [.00381] TIN  
 UNDERPLATE : .000075 [.00191] NICKEL

**MOUNTING STYLE** \_\_\_\_\_

1 = THROUGH HOLE

**COLOR** \_\_\_\_\_

BLANK = BLACK  
 2 = BLUE  
 3 = NATURAL

- MARK "▼" DIMENSION MUST BE CONTROLLED.
  - MARK "(X)" IS DIMENSION No.
  - MARK "(CPK)" DIMENSION MUST BE CONTROLLED BY CPK.
  - MEETS THE REQUIREMENTS OF THE EUROPEAN PARLIAMENT AND THE RESTRICTION OF THE USE OF CERTAIN HAZARDOUS SUBSTANCES IN ELECTRICAL AND ELECTRONIC EQUIPMENT. (RoHS)
  - SPECIFICATIONS :
    - ENVIRONMENTAL :
      - TEMPERATURE RANGE : -55° TO +85° C
    - MECHANICAL :
      - INSULATOR MATERIAL : HIGH TEMPERATURE THERMOPLASTIC COMPOUNDS
      - CONTACT MATERIAL : BRASS
      - BOARDLOCK : BRASS
      - DURABILITY : 50 CYCLES
    - ELECTRICAL :
      - CURRENT RATING : 1.5 AMP
      - INSULATION RESISTANCE : > 1000 MEGOHMS
      - CONTACT RESISTANCE : < 30 MILLIOHMS
  - INTERPRET DIMENSIONS AND TOLERANCES ASME Y14.5M-1994
- NOTE: UNLESS OTHERWISE SPECIFIED

| DIMENSIONS ARE IN INCHES TOLERANCES ARE:                         |        | APPROVALS  | DATE     |
|--|--------|--|----------|
| DECIMALS   | ANGLES | DRAWN CUONG PHAM   | 10-18-01 |
| .XX ±.010  | ±3°    | CHECKED LEROY FONG   | 10-18-01 |
| .XXX ±.005   |        |  |          |
| DIMENSIONS IN BRACKETS [X.XX] ARE IN MILLIMETERS TOLERANCES ARE: |        | THE INFORMATION AND DESIGN DISCLOSED HEREIN WAS ORIGINATED BY AND IS THE PROPERTY OF CIRCUIT ASSEMBLY CORPORATION. CIRCUIT ASSEMBLY CORPORATION RESERVES ALL PATENT, PROPRIETARY, DESIGN, MANUFACTURING, REPRODUCTION, USE AND SALES RIGHTS THERETO, AND TO ANY ARTICLE DISCLOSED HEREIN EXCEPT TO THE EXTENT RIGHTS ARE EXPRESSLY GRANTED TO OTHERS. THE FOREGOING DOES NOT APPLY TO VENDOR PROPRIETARY RIGHTS. |          |
| DECIMALS   | ANGLES |  |          |
| .X ±.25  | ±3°    |  |          |
| .XX ±.13   |        |  |          |
| DO NOT SCALE DRAWING   |        |  |          |

**CA CIRCUIT ASSEMBLY CORP.**  
 6 AUTRY SUITE 150, IRVINEN CALIFORNIA 92618

**CONNECTOR ASSEMBLY HOST MOUNT, PLUG SATA SERIES**

|      |                |             |      |
|------|----------------|-------------|------|
| SIZE | CODE IDENT NO. | DRAWING NO. | REV. |
| C    | 52072          | 620438      | K    |

SCALE: 8 : 1      SHEET 1 OF 1

**RECOMMENDED P.C.B LAYOUT COMPONENT SIDE SHOWN**