

PART NO. CA-XXX-24X-46

| REVISIONS |                             |               |          |
|-----------|-----------------------------|---------------|----------|
| LTR       | DESCRIPTION                 | DATE          | APPROVED |
| A         | INITIAL RELEASE SEE DO 4528 | C.P. 6-31-01  | A.J.     |
| B         | SEE DO 5914                 | C.P. 10-20-05 | L.F.     |
| C         | SEE DO 6036                 | C.P. 03-16-06 | I.M.     |

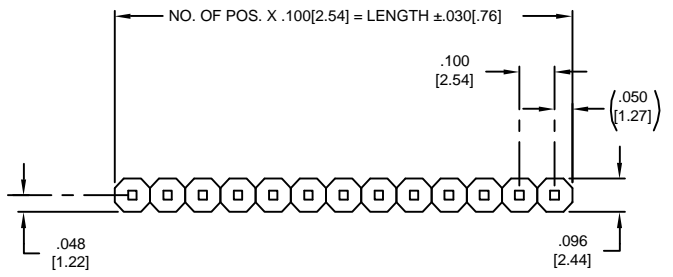

**SINGLE ROW**

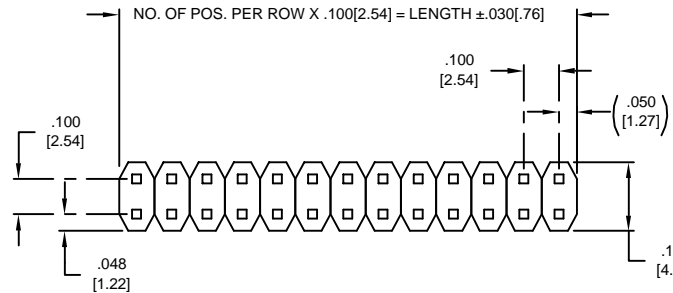
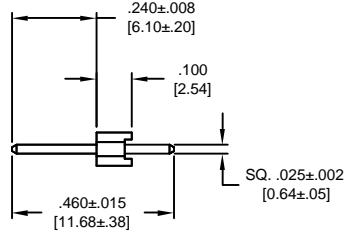

**DUAL ROW**

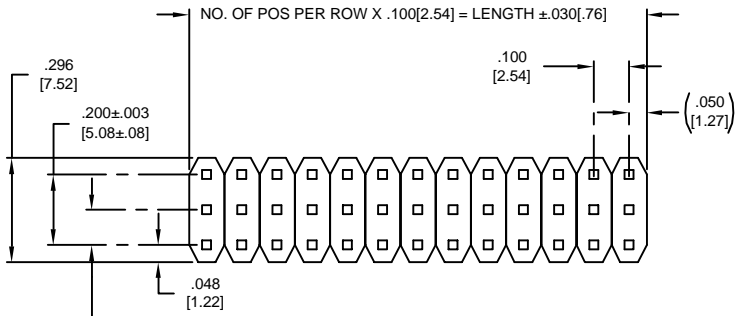
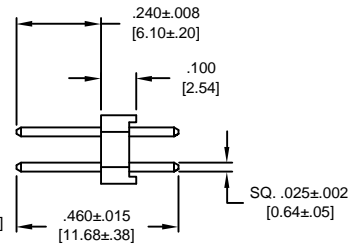

**TRIPLE ROW**

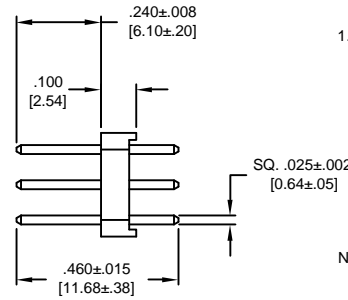

# CA-XXX-24X-46

NO. OF ROW \_\_\_\_\_  
 S = SINGLE ROW  
 D = DUAL ROW  
 T = TRIPLE ROW

NO. OF POSITIONS \_\_\_\_\_  
 SINGLE ROW = 01-40 POSITIONS  
 DUAL ROW = 04-80 POSITIONS  
 TRIPLE ROW = 09-120 POSITIONS

POST EXTENSION \_\_\_\_\_  
 .240 = [6.10]

PIN LENGTH \_\_\_\_\_  
 46 = .460 [11.68]

PLATING \_\_\_\_\_  
 A = GOLD FLASH  
 B = .000010 [.00025] GOLD  
 C = .000015 [.00038] GOLD  
 TAIL AREA : .000150 [.00381] TIN  
 UNDERPLATE : .000075 [.00190] NICKEL  
 T = .000150 TIN OVER .000075 [.00190] NICKEL

2. MEETS THE REQUIREMENTS OF DIRECTIVE 2002/95/EC OF THE EUROPEAN PARLIAMENT AND OF THE COUNCIL OF 27 JANUARY 2003 ON THE RESTRICTION OF THE USE OF CERTAIN HAZARDOUS SUBSTANCES IN ELECTRICAL AND ELECTRONIC EQUIPMENT. (ROSH)

1. SPECIFICATIONS :

- ENVIRONMENTAL :**
  - TEMPERATURE RANGE : -55° TO +120° C
- MECHANICAL :**
  - INSULATOR MATERIAL : GLASS FILLED POLYESTER, BLACK, UL94V-0
  - CONTACT MATERIAL : COPPER ALLOY
- ELECTRICAL :**
  - CURRENT RATING : 1 AMP
  - DIELECTRIC WITHSTANDING VOLTAGE : 500 Vrms
  - INSULATION RESISTANCE : > 1000 Megohms

NOTES : UNLESS OTHERWISE SPECIFIED

|   |  |   |   |
|---|--|---|---|
| DIMENSIONS ARE IN INCHES<br>TOLERANCES ARE:<br>DECIMALS ANGLES<br>.XX ±.010 ±3°<br>.XXX ±.005 | APPROVALS<br>DRAWN CUONG.P<br>CHECKED A.JOCHEN   | DATE<br>6-12-01<br>6-13-01  | CIRCUIT ASSEMBLY CORP.<br>18 THOMAS ST., IRVINE, CALIFORNIA 92618-2777<br><b>CONNECTOR ASSEMBLY</b><br><b>.025" SQ. STRIP-HEADER, VALUE LINE</b><br><b>CA-XXX-24X-46 - "ROHS COMPLIANT"</b> |
|   | DIMENSIONS IN BRACKETS<br>[X.XX] ARE IN MILLIMETERS<br>TOLERANCES ARE:<br>DECIMALS ANGLES<br>.X ±.25 ±3°<br>.XX ±.13 | THE INFORMATION AND DESIGN DISCLOSED HEREIN WAS ORIGINATED BY AND IS THE PROPERTY OF CIRCUIT ASSEMBLY CORPORATION. CIRCUIT ASSEMBLY CORPORATION RESERVES ALL PATENT, PROPRIETARY, DESIGN, MANUFACTURING, REPRODUCTION, USE AND SALES RIGHTS THEREIN. NO TO ANY ARTICLE DISCLOSED HEREIN EXCEPT TO THE EXTENT RIGHTS ARE EXPRESSLY GRANTED TO OTHERS. THE FOREGOING DOES NOT APPLY TO VENDOR PROPRIETARY RIGHTS. |   |
| DO NOT SCALE DRAWING  | SCALE: 4:1   | SHEET 1 OF 1  |   |