

PART NO. CA-XXIDSL-1T-X

REVISIONS

LTR	DESCRIPTION	DATE	APPROVED
A	INITIAL RELEASE SEE DD 3734	JL 11-19-99	A.J
B	SEE DD 4009	JL 05-10-00	A.J
C	SEE DD 4612	C.P 09-05-01	A.J
D	SEE DD 5461	C.P 04-28-04	A.J
E	SEE DD 6273	C.P 11-06-06	I.M
F	SEE DD 6479	C.P 07-10-07	A.J
G	SEE DD 6601	C.P 02-21-08	A.J
H	SEE DD 6955	C.P 04-30-10	A.J
J	SEE DD 7521	C.P 04-19-19	T.L
K	SEE DD 7625	C.P 08-18-21	T.L

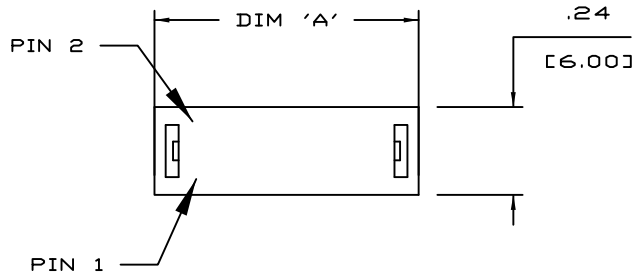

CA-XX IDSL-1T-X

NUMBER OF POSITIONS
 INSULATION DISPLACEMENT SLIM LINE
 TAIL TYPE
 1 = SOLDER TAIL
 PLATING
 T = TIN
 TAIL TYPE
 BLANK = STANDARD
 2 = SELF RETAINING

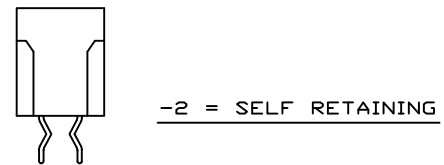
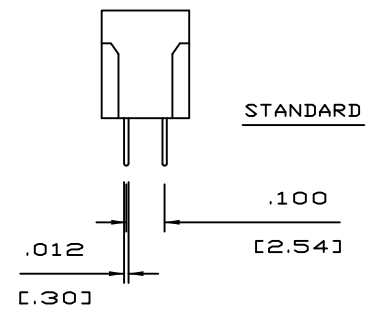
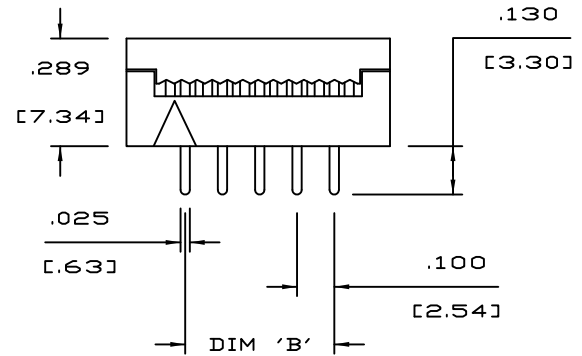

POS	DIM 'A'	DIM 'B'
06	.510 [12.95]	.20 [5.08]
08	.610 [15.49]	.30 [7.62]
10	.710 [18.03]	.40 [10.16]
12	.810 [20.57]	.50 [12.70]
14	.910 [23.11]	.60 [15.24]
16	1.010 [25.65]	.70 [17.78]
20	1.210 [30.73]	.90 [22.86]
24	1.410 [35.81]	1.10 [27.94]
26	1.510 [38.35]	1.20 [30.48]
28	1.610 [40.89]	1.30 [33.02]
30	1.710 [43.43]	1.40 [35.56]
34	1.910 [48.51]	1.60 [40.64]
40	2.210 [56.13]	1.90 [48.26]
50	2.710 [68.83]	2.40 [60.96]
60	3.210 [81.53]	2.90 [73.66]
64	3.410 [86.61]	3.10 [78.74]

3. MEETS THE REQUIREMENTS OF THE EUROPEAN PARLIAMENT AND THE RESTRICTION OF THE USE OF CERTAIN HAZARDOUS SUBSTANCES IN ELECTRICAL AND ELECTRONIC EQUIPMENT. (ROHS)

2. TERMINATES TO: .050 PITCH CABLE, 28 AWG

1. SPECIFICATIONS

ENVIRONMENTAL:

- TEMPERATURE RANGE : -55°C TO 105°C

MECHANICAL:

- INSULATOR MATERIAL : GLASS-FILLED POLYESTER,, BLACK, UL94V-0

- CONTACT MATERIAL : COPPER ALLOY

- CONTACT PLATING (ALL OVER) : .000100" TIN

UNDERPLATE: .000040" NICKEL

ELECTRICAL:

- CURRENT RATING : 1 AMP

NOTES: UNLESS OTHERWISE SPECIFIED

DIMENSIONS ARE IN INCHES TOLERANCES ARE:		APPROVALS	DATE	CIRCUIT ASSEMBLY CORP. 6 AUTRY SUITE 150, IRVINE, CALIFORNIA 92619 CONNECTOR ASSEMBLY-IDSL SERIES IDT SLIM CARD "RoHS"								
DECIMALS	ANGLES	DRAWN J. LANG	11-16-99									
.XX ± .01	± 3°	CHECKED A. JOCHEN	11-16-99	<table border="1"> <tr> <th>SIZE</th> <th>CODE IDENT NO.</th> <th>DRAWING NO.</th> <th>REV.</th> </tr> <tr> <td>C</td> <td>52072</td> <td>620388</td> <td>K</td> </tr> </table>	SIZE	CODE IDENT NO.	DRAWING NO.	REV.	C	52072	620388	K
SIZE	CODE IDENT NO.	DRAWING NO.	REV.									
C	52072	620388	K									
DIMENSIONS IN BRACKETS GROSS ARE IN MILLIMETERS TOLERANCES ARE:		THE INFORMATION AND DESIGN DISCLOSED HEREIN WAS ORIGINATED BY AND IS THE PROPERTY OF CIRCUIT ASSEMBLY CORPORATION. CIRCUIT ASSEMBLY CORPORATION RESERVES ALL PATENT, PROPRIETARY DESIGN, MANUFACTURING, REPRODUCTION, USE AND SALES RIGHTS THERE TO, AND TO ANY ARTICLE DISCLOSED HEREIN EXCEPT TO THE EXTENT RIGHTS ARE EXPRESSLY GRANTED TO OTHERS IN FOREGOING. DOES NOT APPLY TO VENDOR PROPRIETARY RIGHTS.		SCALE: 4 : 1								
DECIMALS	ANGLES	DO NOT SCALE DRAWING		SHEET 1 OF 1								
.X ± .3												
.XX ± .13												