

PART NO. CA-XXNFHR-12GT-XX

REVISIONS

| LTR | DESCRIPTION | DATE | APPROVED |
|-----|------------------------------|------------|----------|
| A | INITIAL RELEASE SEE ECR 1978 | 11-07-91 | J. McA. |
| B | SEE ECD 1748 | 4-13-92 | A.J. |
| C | SEE ECD 2056 | 11-22-93 | A.J. |
| D | SEE ECD 2308 | 4-18-95 | A.J. |
| E | SEE DD 5490 | CP 5-20-04 | A.J. |
| F | SEE DD 6379 | CP 3-05-07 | A.J. |
| G | SEE DD 7195 | CP 5-09-12 | I.M. |
| H | SEE DD 7312 | CP 2-10-15 | I.M. |
| J | SEE DD 7522 | CP 4-30-19 | T.L. |
| K | SEE DD 7624 | CP 8-13-21 | T.L. |

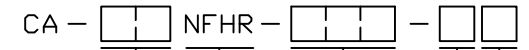
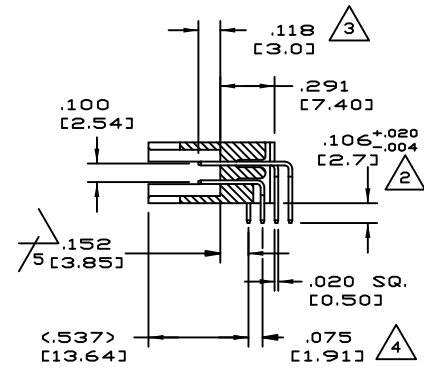
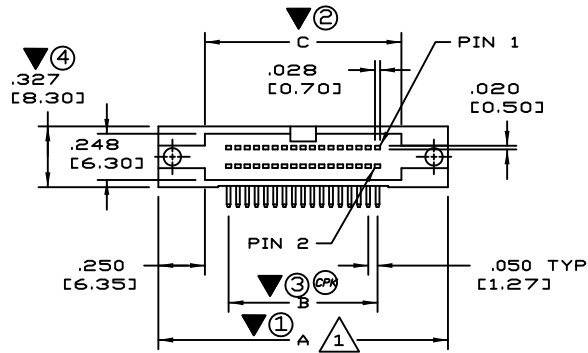
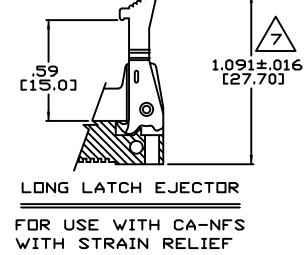
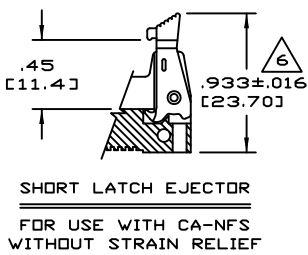
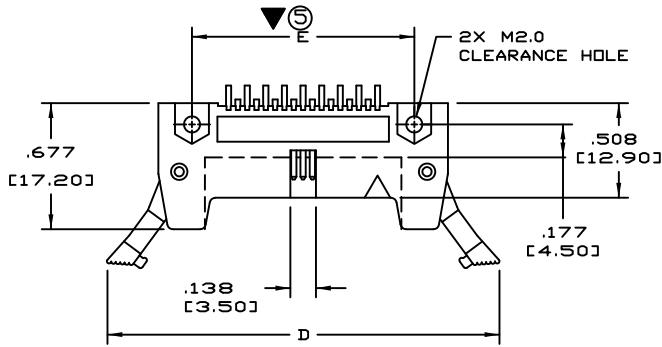

NUMBER OF CONTACT POSITIONS

NANOFLEX RIGHT ANGLE SHROUDED HEADER

PLATING:

12GT = CONTACT AREA: .000012 [.00030] GOLD
TAIL AREA: .000100 [.00254] TIN
UNDERPLATE: .000100 [.00254] NICKEL

LATCH OPTION:

0 = NO LATCH EJECTOR
1 = SHORT LATCH EJECTOR
2 = LONG LATCH EJECTOR

MOUNTING HARDWARE:

0 = NONE

FOR THE FOLLOWING SIZES: 10,26,34 AND 50

P.C.B. HOLE PATTERN (COMPONENT SIDE)

FOR THE FOLLOWING SIZES: 16,20,40,60,64,80 AND 100

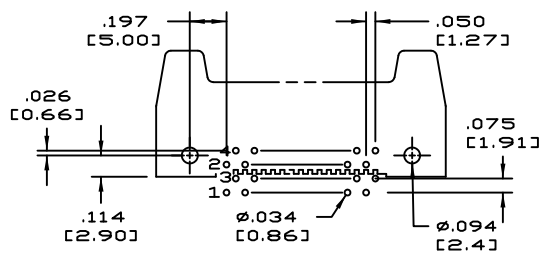
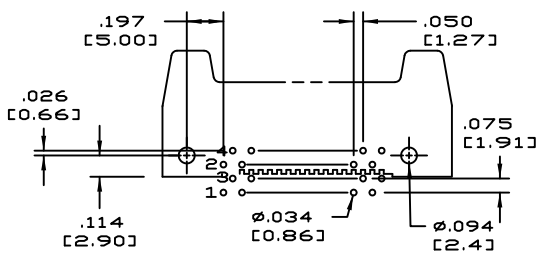

TABULATION:

| NO. OF POSITIONS | A | | B | | C | | LONG | | SHORT | | E | |
|------------------|-------|-------|-------|-------|-------|-------|-------|-------|-------|-------|-------|-------|
| | IN | MM | IN | MM | IN | MM | IN | MM | IN | MM | IN | MM |
| 10 | .955 | 24.28 | .200 | 5.08 | .456 | 11.58 | 1.583 | 40.20 | 1.373 | 34.87 | .594 | 15.08 |
| 16 | 1.105 | 28.09 | .350 | 8.89 | .606 | 15.39 | 1.733 | 44.00 | 1.523 | 38.68 | .744 | 18.89 |
| 20 | 1.205 | 30.63 | .450 | 11.43 | .706 | 17.93 | 1.833 | 46.55 | 1.623 | 41.22 | .844 | 21.43 |
| 26 | 1.355 | 34.44 | .600 | 15.24 | .856 | 21.74 | 1.983 | 50.36 | 1.773 | 45.03 | .994 | 25.24 |
| 34 | 1.555 | 39.52 | .800 | 20.32 | 1.056 | 26.82 | 2.183 | 55.45 | 1.973 | 50.11 | 1.194 | 30.32 |
| 40 | 1.705 | 43.33 | .950 | 24.13 | 1.206 | 30.63 | 2.333 | 59.26 | 2.123 | 53.92 | 1.344 | 34.13 |
| 50 | 1.955 | 49.68 | 1.200 | 30.48 | 1.456 | 36.98 | 2.583 | 65.60 | 2.373 | 60.27 | 1.594 | 40.48 |
| 60 | 2.205 | 56.03 | 1.450 | 36.83 | 1.706 | 43.33 | 2.833 | 71.96 | 2.623 | 66.62 | 1.844 | 46.83 |
| 64 | 2.305 | 58.57 | 1.550 | 39.37 | 1.806 | 45.87 | 2.933 | 74.50 | 2.723 | 69.16 | 1.944 | 49.37 |
| 80 | 2.705 | 68.73 | 1.950 | 49.53 | 2.206 | 56.03 | 3.333 | 84.66 | 3.123 | 79.32 | 2.344 | 59.53 |
| 100 | 3.206 | 81.43 | 2.450 | 62.23 | 2.706 | 68.73 | 3.833 | 97.36 | 3.623 | 92.02 | 2.844 | 72.23 |

- 7. MARK '▽' DIMENSION MUST BE CONTROLLED.
- MARK 'X' IS DIMENSION No.
- MARK 'CP' DIMENSION MUST BE CONTROLLED BY CPK.

- 6. MEETS THE REQUIREMENTS OF THE EUROPEAN PARLIAMENT AND THE RESTRICTION OF THE USE OF CERTAIN HAZARDOUS SUBSTANCES IN ELECTRICAL AND ELECTRONIC EQUIPMENT. (RoHS)
- 5. INTERPRET DIMENSIONS AND TOLERANCES PER ANSI Y14.5M-1994
- 4. 'X' INDICATES INSPECTION CRITERIA LINE ITEM NO.
- 3. INSULATOR MATERIAL: GLASS FILLED POLYESTER, UL94V-0. COLOR: CUSTOM BLUE (PANTONE 298 C -299 C)

- 2. CONTACT MATERIAL: PHOSPHOR BRONZE.
 - 1. FOR DETAIL SPECIFICATIONS, REFER TO DRAWING NUMBER CA-100199.
- NOTES: UNLESS OTHERWISE SPECIFIED.

| | | | | | | | |
|---|--------|--|-------|--------------|-------------|---|--|
| DIMENSIONS ARE IN INCHES TOLERANCES ARE: | | APPROVALS | | DATE | | CIRCUIT ASSEMBLY CORP. | |
| DECIMALS | ANGLES | DRAWN R. PRITCHETT | | 11-06-91 | | 6 AUTRY SUITE 150, IRVINE, CALIFORNIA 92618 | |
| .XX ± .010 | ± 3° | CHECKED J. McALLISTER | | 11-07-91 | | CONNECTOR ASSEMBLY - NFHR | |
| .XXX ± .008 | | THE INFORMATION AND DESIGN DISCLOSED HEREIN WAS ORIGINATED BY AND IS THE PROPERTY OF CIRCUIT ASSEMBLY CORPORATION. CIRCUIT ASSEMBLY CORPORATION RESERVES ALL PATENT, PROPRIETARY, DESIGN, MANUFACTURING, REPRODUCTION, USE AND SALES RIGHTS THEREIN, AND TO ANY ARTICLE DISCLOSED HEREIN EXCEPT TO THE EXTENT RIGHTS ARE EXPRESSLY GRANTED TO OTHERS BY FOREGOING. THIS DOES NOT APPLY TO VENDOR PROPRIETARY RIGHTS. | | | | | |
| DIMENSIONS IN BRACKETS [] ARE IN MILLIMETERS TOLERANCES ARE: | | SIZE | CODE | IDENT NO. | DRAWING NO. | REV. | |
| DECIMALS | ANGLES | C | 52072 | | 620342 | K | |
| .X ± .25 | ± 3° | SCALE: 2 : 1 | | SHEET 1 OF 1 | | | |
| .XX ± .20 | | DO NOT SCALE DRAWING | | | | | |