

4

3

2

1

PART NO. CA-XXSE-XXWW

REVISIONS

LTR	DESCRIPTION	DATE	APPROVED
A	INITIAL RELEASE SEE DO 4544	C.P. 6-27-01	A.J.
B	SEE DO 5782	C.P. 5-31-05	A.J.
C	SEE DO 6314	C.P. 1-03-07	A.J.
D	SEE DO 7286	C.P. 8-28-14	I.M.
E	SEE DO 7525	C.P. 5-10-19	T.L.
F	SEE DO 7618	C.P. 6-25-21	T.L.

ORDERING NOMENCLATURE :

CA-XXSE-XXWW

NO. OF POS. _____

SOCKET END STACKABLE _____

PLATING _____

10 = .000010 [.00025] GOLD OVER .000075 [.00190] NICKEL
T = .000250 [.00635] TIN

④ TAIL LENGTH _____

1 = .31 [7.9]
2 = .41 [10.4]
3 = .63 [16]

WRAP TAIL _____

3. SPECIFICATIONS :

ENVIRONMENTAL :

TEMPERATURE RANGE : -65°C TO +125°C

MECHANICAL :

INSULATOR MATERIAL : GLASS FILLED POLYESTER, BLACK, UL94-0

CONTACT MATERIAL : PHOSPHOR BRONZE

CONTACT PLATING : SEE ORDERING NOMENCLATURE

CONTACT INSERTION FORCE : *

6.2 oz. [1.7 N.] TYP
10.6 oz. [2.9 N.] MAX.* MEASURED WITH .020 [0.51] DIA. PIN
CONTACT EXTRACTION FORCE : *1.8 oz. [0.5 N.] TYP
0.7 oz. [0.2 N.] MIN.

* MEASURED WITH .0145 [0.37] DIA. PIN

RECOMMENDED MATING PIN SIZE : .022 [0.56] W X .020 [0.51] T MAX.
.010 [0.25] W X .008 [0.20] T MIN.ELECTRICAL :CURRENT RATING : 1 AMP
VOLTAGE RATING : 300 Vrms
DIELECTRIC WITHSTANDING VOLTAGE : 500 Vrms MIN.
INSULATION RESISTANCE : > 5000 Megohms
CONTACT RESISTANCE : 10 Milliohms TYP.
30 Milliohms MAX.

2. MARK "▼" DIMENSION MUST BE CONTROLLED.

MARK "⊗" IS DIMENSION NO.

MARK "⊙" MUST BE CONTROLLED BY CPK.

1. MEETS THE REQUIREMENTS OF THE EUROPEAN PARLIAMENT AND THE RESTRICTION OF THE USE OF CERTAIN HAZARDOUS SUBSTANCES IN ELECTRICAL AND ELECTRONIC EQUIPMENT. (RoHS)

NOTES : UNLESS OTHERWISE SPECIFIED

D

C

B

A

D

C

B

A

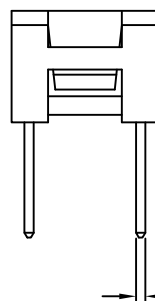
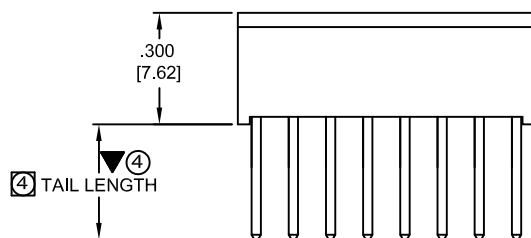
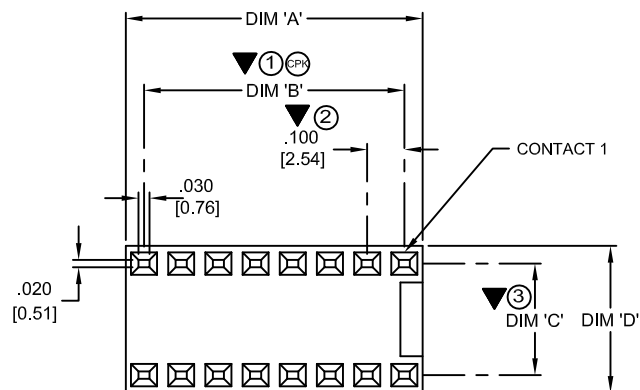

TABULATION :

NO. OF POS	DIM 'A'		DIM 'B'		DIM 'C'		DIM 'D'	
	IN	MM	IN	MM	IN	MM	IN	MM
* 08	.398	[10.11]	.300	[7.62]	.300	[7.62]	.395	[10.03]
14	.698	[17.73]	.600	[15.24]	.300	[7.62]	.395	[10.03]
16	.798	[20.27]	.700	[17.78]	.300	[7.62]	.395	[10.03]

* 08 POSITION DISCONTINUED 05/2005

DIMENSIONS ARE IN INCHES
TOLERANCES ARE:DECIMALS ANGLES
.XX ± .010
.XXX ± .005 ± 3°DIMENSIONS IN BRACKETS
(XXX) ARE IN MILLIMETERS
TOLERANCES ARE:DECIMALS ANGLES
X ± .25
XX ± .13 ± 3°

DO NOT SCALE DRAWING

APPROVALS DATE

DRAWN CUONG P 6-27-01

CHECKED A.JOCHEN 6-27-01

THE INFORMATION AND DESIGN DISCLOSED HEREIN WAS ORIGINATED BY AND IS THE PROPERTY OF CIRCUIT ASSEMBLY CORPORATION. CIRCUIT ASSEMBLY CORPORATION RESERVES ALL PATENT, PROPRIETARY, DESIGN, MANUFACTURING, REPRODUCTION, USE AND SALES RIGHTS THEREIN, AND TO ANY ARTICLE, DISCLOSED HEREIN EXCEPT TO THE EXTENT RIGHTS ARE EXPRESSLY GRANTED TO OTHERS. THE FOREGOING DOES NOT APPLY TO VENDOR PROPRIETARY RIGHTS.

SIZE CODE IDENT NO. DRAWING NO.

C 52072

SCALE: 4 : 1

SHEET 1 OF 1

CIRCUIT ASSEMBLY CORP.
6 AUTRY SUITE 150, IRVINE, CALIFORNIA 92618

SOCKET STANDARD - SE SERIES

END STACKABLE, WRAP TAIL .300" HIGH

CA-XXSE-XXWW - " RoHS"

REV. F

610217

SCALE: 4 : 1 SHEET 1 OF 1

4

3

2

1