

4

3

2

1

PART NO. CA-XXDSID-X-X-SR

CA-09, -15, -37DSID-X-SR SHOWN

REVISIONS			
LTR	DESCRIPTION	DATE	APPROVED
A	INITIAL RELEASE SEE ECR 1846		
B	SEE DO 3787	DL 11-22-99	A.J.
C	SEE DO 3849	DL 2-2-00	A.J.
D	SEE DO 4711	CP 12-12-01	A.J.
E	SEE DO 5589	CP 09-03-04	A.J.
F	SEE DO 5715	CP 03-03-05	A.J.
G	SEE DO 6159	CP 07-27-06	I.M.
H	SEE DO 6907	CP 10-23-09	I.M.
J	SEE DO 7366	CP 07-20-16	I.M.
K	SEE DO 7492	CP 12-03-18	T.L.
L	SEE DO 7607	CP 03-22-21	T.L.

D

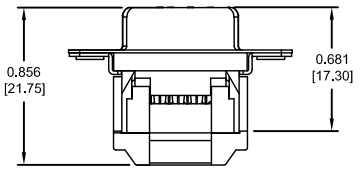
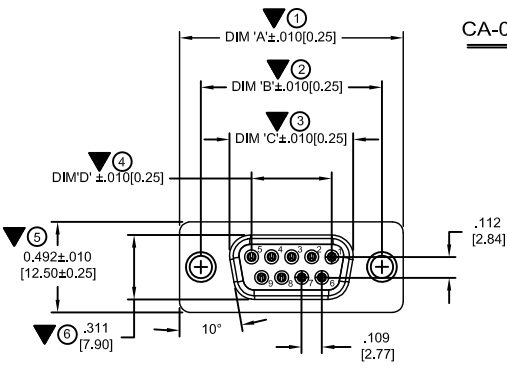

C

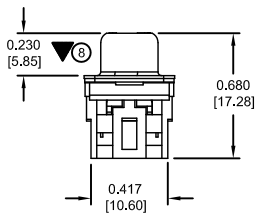
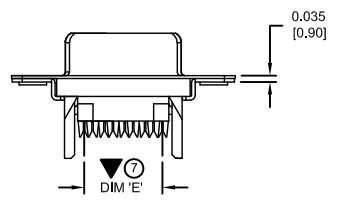

B

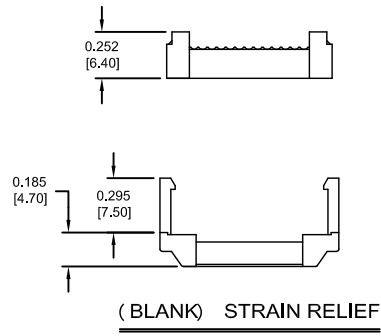

(BLANK) STRAIN RELIEF

ORDERING NOMENCLATURE:

CA - XX - DSID - X - X - SR

NUMBER OF PIN POSITIONS

"D" SUBMINIATURE SOCKET, INSULATION DISPLACEMENT

PLATING

BLANK = GOLD FLASH ON CONTACT AREA  
A5 = .000005" GOLD ON CONTACT AREA  
F = .000030" GOLD ON CONTACT AREA

MOUNTING HOLE OPTIONS

BLANK = Ø.120 [3.05] THRU HOLES  
4 = #4-40 THREADED INSERT

STRAIN RELIEF

7. MARK ▼ DIMENSION MUST BE CONTROLLED  
MARK ⊗ IS DIMENSION NO.

6. MEETS THE REQUIREMENTS OF THE EUROPEAN PARLIAMENT AND THE RESTRICTION OF THE USE OF CERTAIN HAZARDOUS SUBSTANCES IN ELECTRICAL AND ELECTRONIC EQUIPMENT. (RoHS)

4. PLATING:  
UNDERPLATE: NICKEL  
MATING AREA: SEE ORDERING NOMENCLATURE PLATING  
IDT AREA: TIN  
SHELL PLATING: TIN

3. LIST MATERIALS:  
INSULATOR MATERIAL: PBT GLASS FIBER, BLACK, UL94V-0  
SHELL: MATERIAL: SPCC  
CONTACT MATERIAL: BRASS

2. ELECTRICAL  
CURRENT RATING: 1 AMP AC, DC  
VOLTAGE RATING: 250V AC, DC  
TEMPERATURE RANGE: -40°C TO +105°C  
CONTACT RESISTANCE: 20MEG OHMS MAX.  
INSULATION RESISTANCE: 1000MEG OHMS MIN.  
WITHSTANDING VOLTAGE: 500V AC MIN.

1. TERMINATES TO .050" PITCH. 26 AWG OR 28AWG CABLE

NOTES: UNLESS OTHERWISE SPECIFIED

TABULATION:

NO OF POSITION	DIM 'A'		DIM 'B'		DIM 'C'		DIM 'D'		DIM 'E'	
	INCH	MM	INCH	MM	INCH	MM	INCH	MM	INCH	MM
-9	1.21	30.80	0.984	25.00	0.644	16.35	0.436	11.08	0.40	10.16
-15	1.54	39.14	1.311	33.30	0.974	24.75	0.763	19.39	0.70	17.78
-25	2.09	53.05	1.852	47.04	1.510	38.35	1.309	33.24	1.20	30.48
-37	2.73	69.32	2.500	63.50	2.156	54.75	1.963	49.86	1.80	45.72

A

APPROVALS		DATE	CIRCUIT ASSEMBLY CORP.		
DRAWN	D. LANG	11-22-99	6 AUTRY SUITE 150, IRVINE, CALIFORNIA 92618		
CHECKED	A. JOCHEN	11-22-99	CONNECTOR ASSEMBLY -DSID SERIES		
THE INFORMATION AND DESIGN DISCLOSED HEREIN WAS ORIGINATED BY AND IS THE PROPERTY OF CIRCUIT ASSEMBLY CORPORATION. CIRCUIT ASSEMBLY CORPORATION RESERVES ALL PATENT, PROPRIETARY, DESIGN, MANUFACTURING, REPRODUCTION, USE AND SALES RIGHTS HERETO, AND TO ANY ARTICLE DISCLOSED HEREIN EXCEPT TO THE EXTENT RIGHTS ARE EXPRESSLY GRANTED TO OTHERS. THE FOREGOING DOES NOT APPLY TO VENDOR PROPRIETARY RIGHTS.			SIZE	CODE IDENT NO.	DRAWING NO.
DO NOT SCALE DRAWING			C	52072	610166
			SCALE: 2:1	SHEET 1 OF 2	

D

C

B

A

4

3

2

1

REVISIONS			
LTR	DESCRIPTION	DATE	APPROVED
	SEE SHEET 1 OF 2		

**CA-25DSID-X-SR SHOWN**

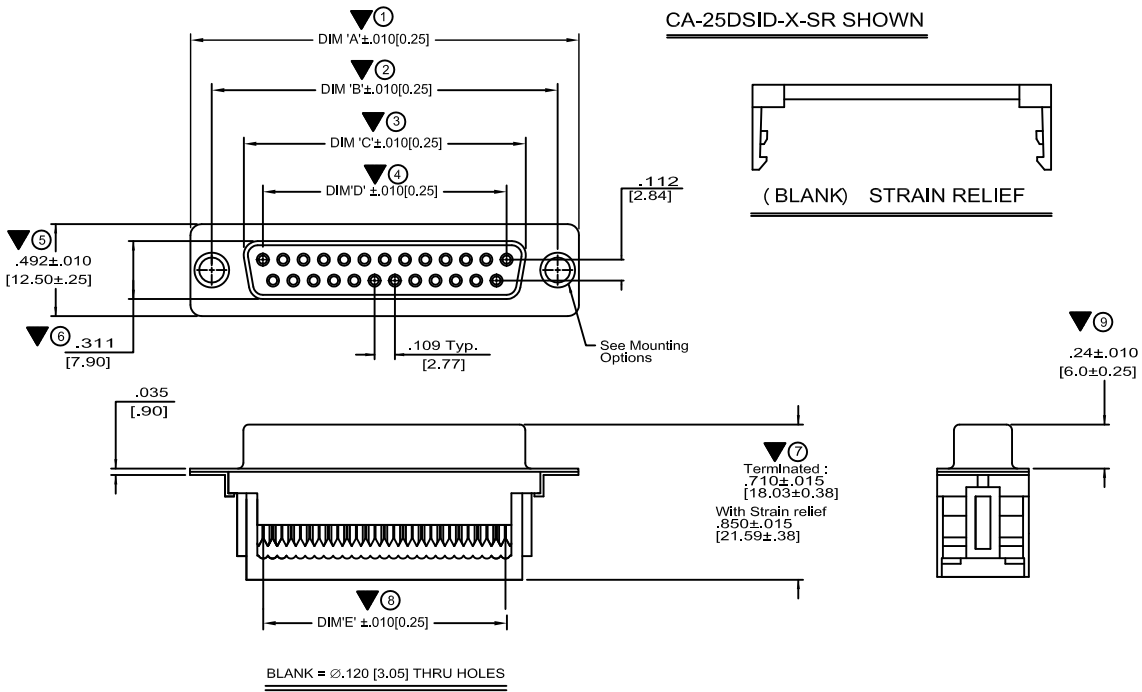

**CA-XXDSID-X-4-SR SHOWN**

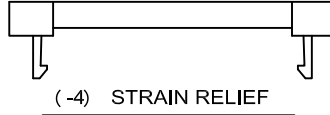
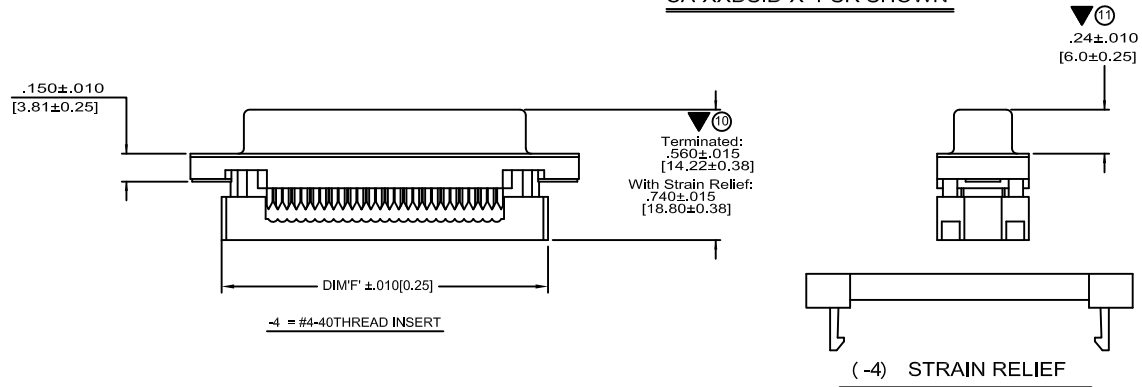

**TABULATION:**

NO OF POSITION	DIM 'A'		DIM 'B'		DIM 'C'		DIM 'D'		DIM 'E'		DIM 'F'	
	INCH	MM	INCH	MM	INCH	MM	INCH	MM	INCH	MM	INCH	MM
-9	1.21	30.80	0.984	25.00	0.644	16.35	0.436	11.08	0.40	10.16	0.89	22.50
-15	1.54	39.14	1.311	33.30	0.974	24.75	0.763	19.39	0.70	17.78	1.21	30.80
-25	2.09	53.05	1.852	47.04	1.510	38.35	1.309	33.24	1.20	30.48	1.76	44.70
-37	2.73	69.32	2.500	63.50	2.156	54.75	1.963	49.86	1.80	45.72	2.41	61.30

DIMENSIONS ARE IN INCHES  
TOLERANCES ARE:  
DECIMALS ANGLES  
XX  $\pm 0.10$   $\pm 3^\circ$   
XXX  $\pm 0.005$   
DIMENSIONS IN BRACKETS  
[XXX] ARE IN MILLIMETERS  
TOLERANCES ARE:  
DECIMALS ANGLES  
X  $\pm 0.25$   $\pm 3^\circ$   
XX  $\pm 0.13$

APPROVALS		DATE
DRAWN	D. LANG	11-22-99
CHECKED	A. JOCHEN	11-22-99

**CA** CIRCUIT ASSEMBLY CORP.  
6 AUTRY SUITE 150, IRVINE, CALIFORNIA 92618

**CONNECTOR ASSEMBLY -DSID SERIES  
CA-XXDSID-X-X-SR  
"RoHS"**

SIZE	CODE IDENT NO.	DRAWING NO.	REV.
C	52072	610166	L

SCALE: 2:1 SHEET 2 OF 2

DO NOT SCALE DRAWING