

PLCC PACKAGING SOCKET, .177" HIGH, SURFACE MOUNT

SPECIFICATIONS

ENVIRONMENTAL

Temperature Range: -55°C to +105°C
Heat Deflection: +220°C

MECHANICAL

Insulator Material: Glass-filled polyphenylene sulfide brown, UL94V-0

Contact Material: Copper Alloy

Contact Plating: 250µ IN Tin

ELECTRICAL

Current Rating: 1 AMP

Consult factory for additional options

CA- POSITION SPCL-3T

POSITION	
20	52
28	68
32	84
44	

DIMENSIONS				
Position	A	B	C	D
20	.617 [15.67]	.200 [5.08]	.200 [5.08]	.617 [15.67]
28	.720 [18.29]	.300 [7.62]	.300 [7.62]	.720 [18.29]
32	.818 [20.78]	.400 [10.16]	.300 [7.62]	.720 [18.29]
44	.917 [23.29]	.500 [12.70]	.500 [12.70]	.917 [23.29]
52	1.019 [25.88]	.600 [15.24]	.600 [15.24]	1.019 [25.88]
68	1.220 [30.99]	.800 [20.32]	.800 [20.32]	1.220 [30.99]
84	1.420 [36.07]	1.000 [25.40]	1.000 [25.40]	1.420 [36.07]

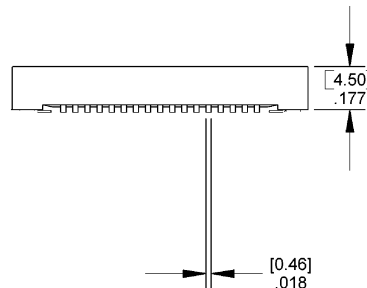
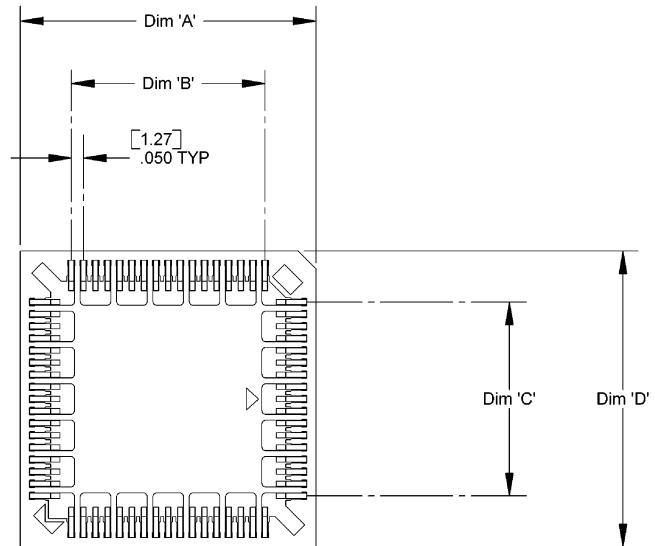

Mating Product: board mount
Drawing Number CA-610214



For more information please contact our customer service department or visit our website at circuitassembly.com

Circuit Assembly Worldwide Hqtrs. 18 Thomas Street, Irvine, CA 92618-2777 USA Tel 1-949-855-7887 Fax 1-949-855-4298

