



Pitch: .100"

## MODULAR, .025" SQUARE SYSTEM, SHORTING JUMPERS

### SPECIFICATIONS

#### ENVIRONMENTAL

Temperature Range: -55°C to +105°C

#### MECHANICAL

Insulator Material: Glass-filled polyester, black, UL94V-0

Contact Material: Copper Alloy

Contact Plating: See options below

#### ELECTRICAL

Current Rating: 2 AMP

Consult factory for additional options

CA-02SJ [INSULATOR] - [PLATING]

INSULATOR	PLATING
O = Open Top	A = Gold flash
C = Closed Top	B = 10 $\mu$ IN gold

5

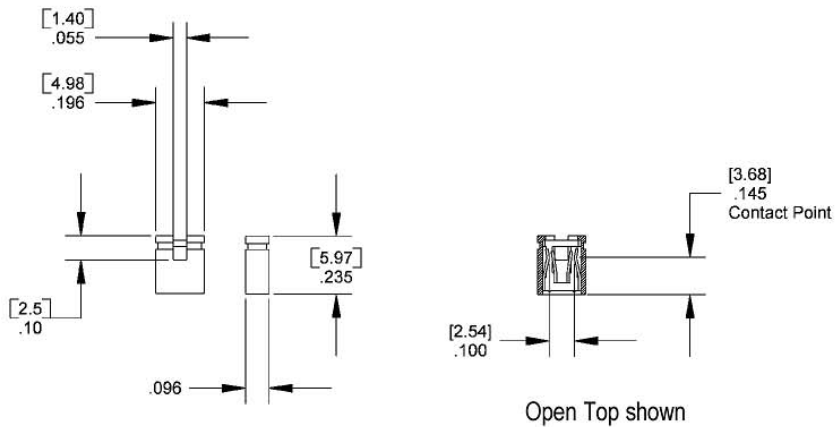

Mating Product: .100" strip headers (page 111-113)

Drawing Number: CA-610275 (open top)

Drawing Number: CA-610219 (closed top)

